

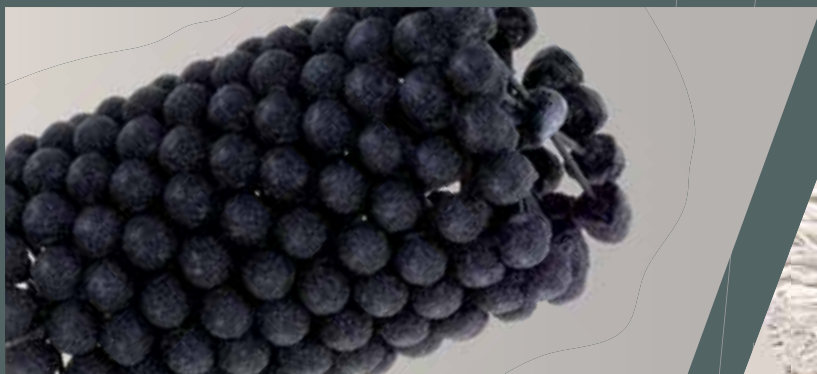

General Catalogue



JAZ-ZUBIAURRE S.A.



JAZZ

JAZ-ZUBIAURRE S.A.



JAZ ZUBIAURRE S.A. has specialized in the manufacturing and sale of wire brushes and abrasive nylon for surface treatment since 1924 and we are focused on distributing our products in the industrial/professional and D.I.Y. markets. We are the clear market leader in the Spanish market and we export most of our production to 55 countries worldwide with special activity in the USA where we operate through our subsidiary JAZ USA Inc.

The vision of JAZ ZUBIAURRE, S.A. staff is the improvement of our competitiveness through our teamwork in quality, productivity and innovation. We are widely known and recognized in the brush manufacturing sector and in the recent years we have developed important worldwide novelties as the protective guarded brushes, laminated wire brushes, multithreaded nut and a new safety handling system, as well as improvements in materials, products and processes.

Quality Assurance

Since 1996 our Quality Assurance System complies with the requirements of the standard UNE-EN ISO 9001:2000 Quality System and basing on that, we have been developing our systems of Health and Safety at Work, Training, Continuous Improvement Program and Innovation. In this last area, we have developed important worldwide novelties that have been registered as international patents and also honored with awards in technological innovation.





In JAZ ZUBIAURRE, S.A. we work as a team and we share the aim of being an enterprise that offers different products and solutions for surface treatment applications. This allows us to provide satisfaction and profitability to our customers, as well as being a reference of quality, service and innovation for them.

/ Jaz Management System

In JAZ we adapt to changes through the increasing of knowledge and the generation of new opportunities. For this objective we work systematically in the 5 key areas for our competitiveness:

/ Quality Assurance Program

/ Training

/ Health and Safety at Work

/ Productivity

/ Innovation



/ Activity

Wire brushes: A wide range of standard articles for industrial supplies and professional hardware sectors.

Technical brushes: We offer new brushing solutions for different industrial applications and areas.

Street Cleaning Brushes: JAZ manufactures high quality street cleaning brushes. These sorts of brushes are addressed for enterprises, communities and municipalities.



/ Novelties

Expansion in the range of Abrasive Nylon. Adding CON brushes range. Another development to remark is FLEXIBLE HONE, an innovative tool to improve the inside finishing of internal diameters.



/ Internationalization

JAZ USA, Inc: Through our subsidiary company in Rhode Island, we offer a wide range of wire brushes and application solutions to our customers in USA and Canada.

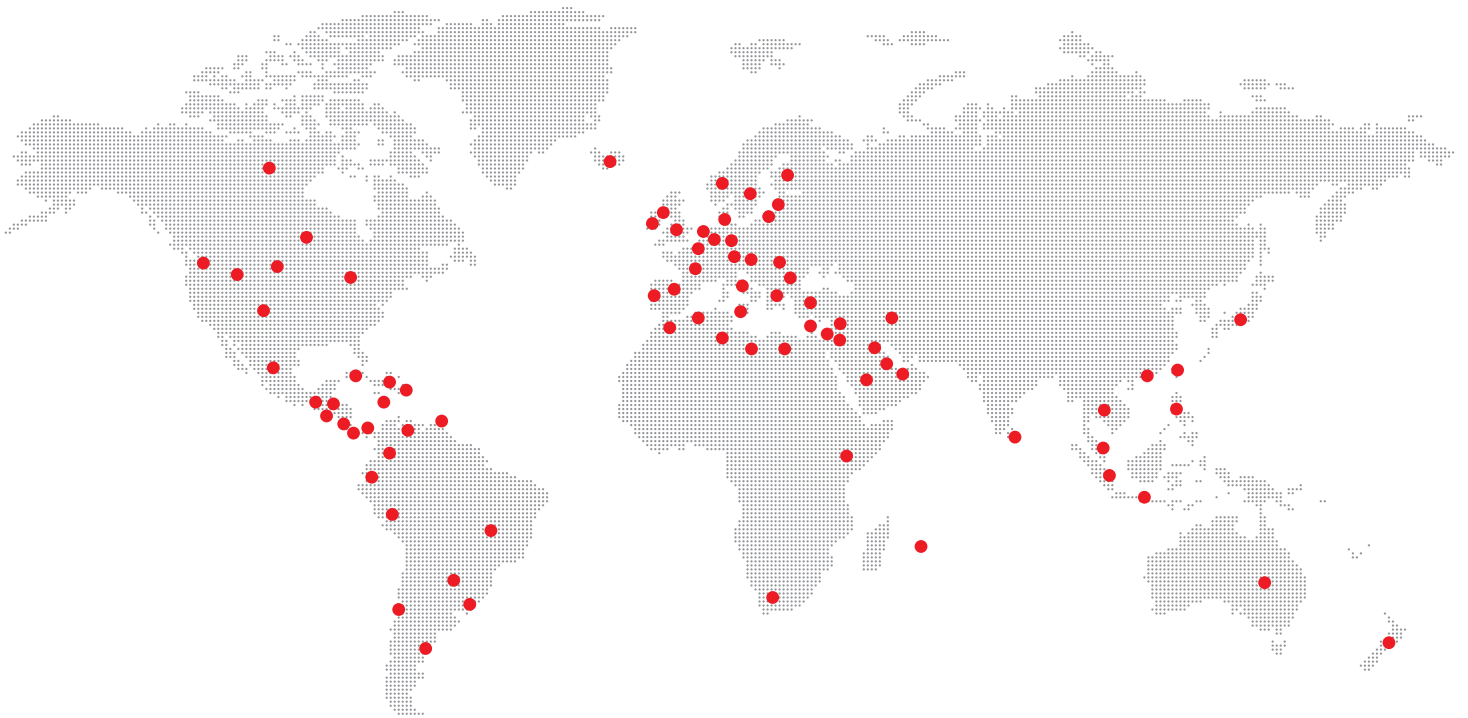

In JAZ we export most of our production to 55 countries worldwide with special activity in the USA where we operate through our subsidiary JAZ USA Inc, who gives service to our customers in USA.

/ Innovation



In JAZ innovation is the systematic search for changes in the market and the analysis of the opportunities offered by such changes. In recent years we have developed and registered new international patents and we have received awards in technological innovation.





INDEX



1. Technical Information

	Technical Information about Products, Materials and Applications	12-18
	Technical Brushes	19



2. Wire Brushes

	2.1 Crimped Wire Wheels CT, CU, CCA, G, CDO	22-29
	2.2 Brushes for Deburring Machines CT, CCA, CUCB, BC SE	30-32
	2.3 Twist Knot Wheels CAM, CA, CPL	33-36
	2.4 Crimped Cup Brushes TO, TCA	37-38
	2.5 Twist Knot Cup Brushes TT, TA	39-40
	2.6 High Speed Line Brushes HS Line (Crimped and Twist Knotted)	41-42
	2.7 Brushes with Protection Guard Cups, HS Line and DIY Line	43-44
	2.8 Laminated Brushes Brushes and HS Line (Crimped and Twist Knotted)	45-46
	2.9 Other Industrial Brushes B, CDE, CAE, CAM with Shank	47-50
	2.10 Wire, Hair and Nylon Tube Brushes L1/L2, LB, LR, LNY	51-53
	2.11 Hand Brushes VIP, MS, MF, MFG, Sleeping Brooms and other hand brushes	54-57
	2.12 DIY Brushes BDER, BTE, BDOR, CAE, BBC	58-59
	2.13 Exhibitors and Assortment Boxes SURT, CNA, SURT, EXP	60-62

3. Flexible Abrasives

	3.1. FH Flexible Grinding	64-65
	3.2. Abrasive Nylon DNA, TNA, CON, LNA, BNA, CNA	66-70
	3.3. Coated Abrasives DL, AL	71-72

4. Technical Brushes

	4.1. Strip Brushes	74-75
	4.2. Inserted Technical Brushes	76
	4.3. Brushing Equipments	77

5. Street Cleaning Brushes

	5.1. Street Cleaning Brushes Side and Central Discs, Rings PR and Separators	80-81
---	---	-------

6. Plans

	CT, CUCB, CAM, TO, TT, End Brushes, Tube Brushes, DNA	84-91
---	---	-------

In our Catalogue we offer a wide range of new and unique products for your brushing and surface treatment solutions. JAZ'S color coding system used in each page will help you identify the different parts of our Catalogue: technical information, wire brushes, flexible abrasives, technical solutions for the brushing and street cleaning brushes.

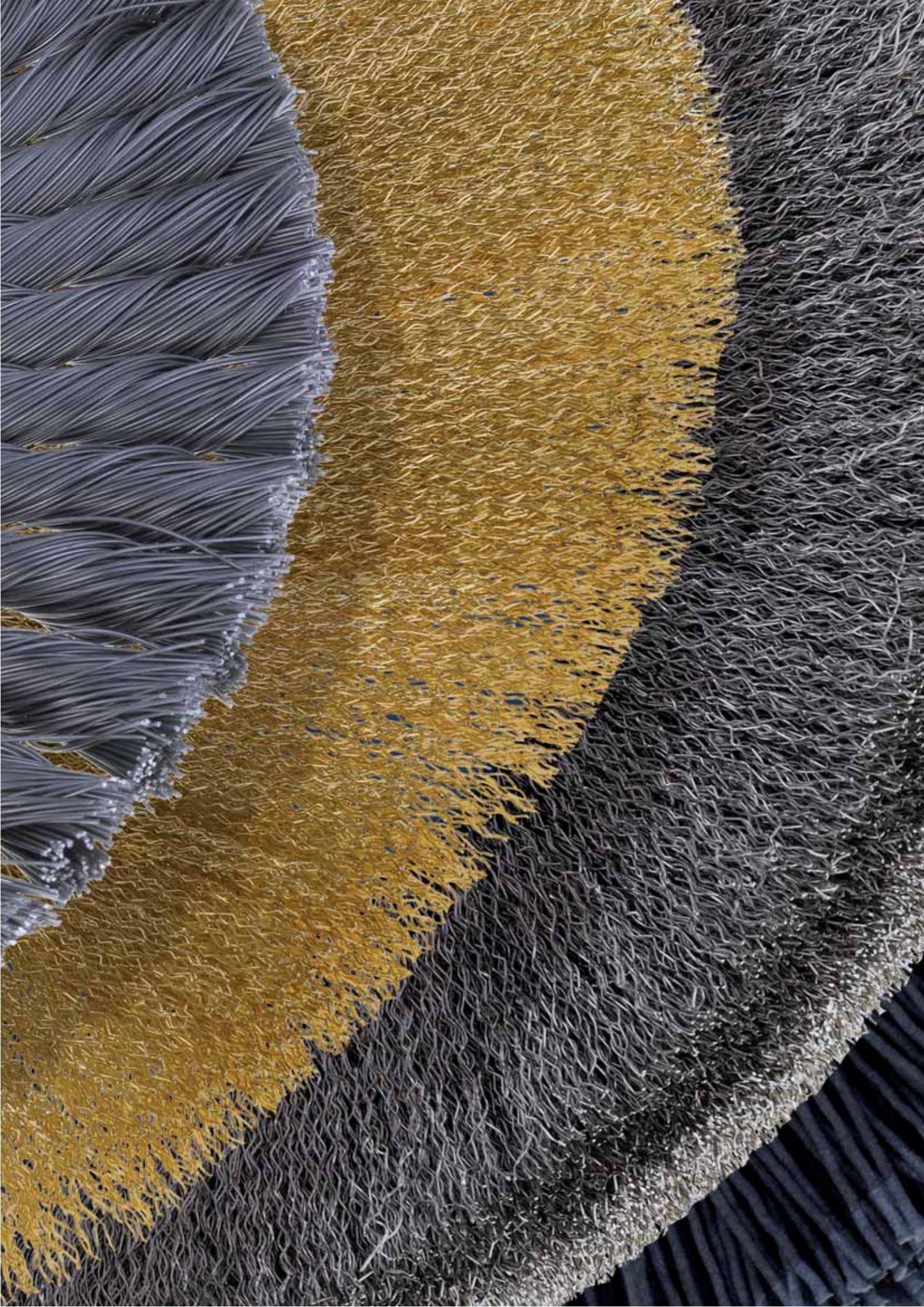



/ 01

Technical Information



Technical Brush information

TECHNICAL INFORMATION



The selection of the right type of brush depends on the type of finishing required (fine or coarse), and the characteristics of the surface to be brushed (stainless steel, carbon steel, wood, etc...).

Besides that, in the case of the brushes fixed in a machine, it is necessary to know the main features of the machine in order to choose the right brush type:

- The maximum diameter allowed.
- The machine speed or RPM.
- The arbor hole diameter or the thread type (M14, 5/8"-11, etc...).

Crimped Wire, Twisted Knot Wire and Nylon



Crimped wire brushes, because of their higher flexibility, are appropriate to work on uneven surfaces and they obtain a more regular and fine finishing.

Twist knot wire, offers longer life and a higher removal capacity but a more rough finishing.

Nylon brushes have the flexibility of crimped wire and offers a smoother finishing.

Wire Diameter and Characteristics of Nylon

- Wire gauge of a brush determines the type of surface finishing:
- A thicker wire provides for a more aggressive brushing action..
- The larger the nylon grit size is the smoother finishing you get.

Trim Length

A short trim length makes the brush face rigid and consequently the brush removal capacity is higher.

With a longer trim length the brush becomes flexible and it provides a uniform brushing even on irregular surfaces.

Wire Brushes Vs. Hard Abrasives

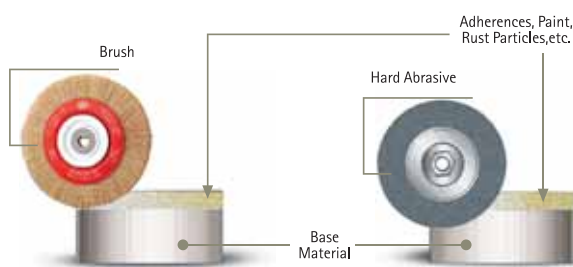

Wire brushes act as an impact tool removing oxide, paint or other adherence from the surface without damaging the base material, as opposed to hard abrasives which will remove the base material along with the surface adherence.

Wire brushes are much more flexible allowing the ability to clean difficult areas to reach and adapt to irregular surfaces, which bonded and coated abrasives can not.

MACHINE Normal Speed	MOST COMMON BRUSHES	MODEL	BRUSH DIAMETER
Bench Grinders	Crimped & Knotted Wheels	CT, CU, CAM, CCA, DNA, CTP	75 mm (3") TO 350 mm (14")
	Crimped & Knotted Wheels	CT, CAM, CPL, CCA, CTP	100 mm (4") TO 175 mm (7")
Angle Grinders (5,000 - 8,500 RPM)	Crimped & Knotted Cups	TO, TI, TCA, TOG, TTG, TCAG, TNA, TOP, TTP	80 mm (3.1/4") TO 150 mm (6")
	Flap Discs	DLZ, DLO	
Mini Angle Grinders (10,000 - 12,500 RPM)	High Speed Cups, Discs & Wheels	HSC, HST, HSD, HSK, HSP, HSR, HCA, HSCG, HSTG, HCAG, HSKG, HSDG, HSCP, HSTP, HSRP	65 mm (2.9/16") TO 115 mm (4.1/2")
	Flap Discs	DLZ, DLO	
Drill & Pneumatic Tools (15,000 - 20,000 RPM)	Wheels & End Brushes with Shank	CDE, CAE, B	12 mm (1/2") TO 75 mm (3")
	Flap Wheels	AL	
Drills (4,500 RPM)	Wheels, Cups & End Brushes with Shank	BDER, BTE, BBC, BDOR, CNA	26 mm (1") TO 100 mm (4")
	Flap Wheels	AL	

Technical Brush information

TECHNICAL INFORMATION

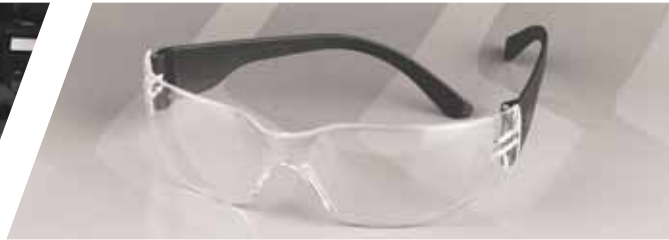

Brush Usage Recommendations

The brushing must be performed with wire ends.

Excessive pressure causes over-bending of the wires, increasing their fatigue and therefore, causing a premature breaking, reducing significantly their working life.

If you need a higher removal capacity, instead of higher pressure on the brush, we suggest the following:

- Use a more aggressive brush: A brush with a thicker wire, with less trim length or twist knot wire instead crimped wire.
- Increase the brushing speed with a model who can work faster or with a bigger diameter, in the case of the wheel brushes.

Safety Warnings

The European Standard EN 1083-2 about Safety Requirements in the use of Power-driven brushes states the safety instructions that all brush operators must observe. These requirements and common safety practices will reduce the likelihood of physical injury and brush fail:

- Wear safety goggles, protective clothing and equipment.
- Observe all speed restrictions indicated on the brushes, packaging or catalogue. And do not exceed Maximum Safe Free Speed (Max. R.P.M.) under any circumstances.
- Keep all machine guards in place.
- Do not use deteriorated brushes.
- Oxidation or any other chemical alteration in the wire may cause malfunctioning.
- Store brushes in original packaging, in a clean and dry location protected from dust, humidity and other environmental effects, gases, etc).

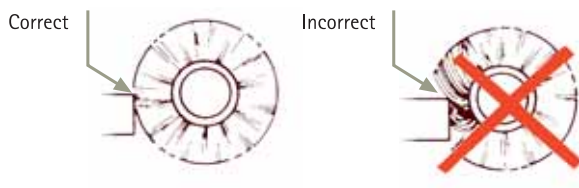

New Colours

From now on, to help our customers to identify the different types of wire of our brushes, we show in the plates the colour range already used on the labels.



Technical Brush information

TECHNICAL INFORMATION

RPM

The power tool speed influences the performance of the brush and the safety of the operator. If load speed marked on the power tool is higher than the brush MAXIMUM RPM, do not mount the brush. Maximum RPM are indicated on brush side plates and shall never be exceeded. MAXIMUM RPM are the maximum RPM at which the brush could be run with no work applied (spinning free). It is merely a safety indication for the user, not the recommended operating speed.

Peripheral Speed (m/s)

REMOVAL	STEEL	STAINLESS STEEL AND BRASS	NYLON
Burr	25-35m/s	20-25m/s	15-20m/s
Weld pass	40-45m/s	35-35m/s	
Oxides, varnishes, corrosion	30-35m/s	20-25m/s	15-20m/s
Paints and scales	40-45m/s	35-35m/s	

Converting m/sec in ft/min: 1 m/sec = 197 ft/min
1ft/min=5,08 m/sec

n [r.p.m.]	Brush Ø d1 [mm]															
	25	30	40	50	60	75	80	100	115	125	150	175	200	250	300	
1.000	1	2	2	3	3	4	4	5	6	7	8	9	10	13	16	
1.250	2	2	3	3	4	5	5	7	8	8	10	11	13	16	20	
1.500	2	2	3	4	5	6	6	8	9	10	12	14	16	20	24	
1.750	2	3	4	5	5	7	7	9	11	11	14	16	18	23	27	
2.000	3	3	4	5	6	8	8	10	12	13	16	18	21	26	31	
2.500	3	4	5	7	8	10	10	13	15	16	20	23	26	33	39	
3.000	4	5	6	8	9	12	13	16	18	20	24	27	31	39	47	
3.500	5	5	7	9	11	14	15	18	21	23	27	32	37	46	55	
4.000	5	6	8	10	13	16	17	21	24	26	31	37	42	52	63	
4.500	6	7	9	12	14	18	19	24	27	29	35	41	47	59	71	
5.000	7	8	10	13	16	20	21	26	30	33	39	46	52	65	79	
5.500	7	9	12	14	17	22	23	29	33	36	43	50	58	72		
6.000	8	9	13	16	19	24	25	31	36	39	47	55	63	79		
6.500	9	10	14	17	20	26	27	34	39	43	51	60	68			
7.000	9	11	15	18	22	27	29	37	42	46	55	64	73			
7.500	10	12	16	20	24	29	31	39	45	49	59	69	79			
8.000	10	13	17	21	25	31	34	42	48	52	63	73				
10.000	13	16	21	26	31	39	42	52	60	65	79					
12.000	16	19	25	31	38	47	50	63	72	79						
14.000	18	22	29	37	44	55	59	73								
16.000	21	25	34	42	50	63	67									
20.000	26	31	42	52	63	79										
22.000	29	35	46	58	69											
25.000	33	39	52	65	79											

Example
Brush diameter d₁=150mm
R.P.M.: 3,000 r.p.m
Cutting Speed: 24m/s

R.P.M: 5,000 r.p.m.
Cutting speed (v) = $\frac{d_1 \times \pi \times n}{1.000 \times 60}$

MATERIAL	Ø mm	Ø "	WIRE CODE
Grey Steel	0,12	.005	A
Brass Coated Steel	0,15	.006	B
	0,20	.008	C
	0,25	.010	D
	0,30	.012	E
	0,35	.014	F
	0,40	.016	G
	0,50	.020	H
	12 x 0,23	12 x .009	#
	6x 0,353 + 3x 0,20	6x .014 + 3x .008	@
Stainless Steel	0,15	.006	M
	0,20	.008	N
	0,30	.012	Z
	0,40	.016	P
	0,50	.020	Q
	7 x 0,35	7 x .013	@Z
Brass	0,08	.003	U
	0,30	.012	V
	0,40	.016	X
Grey Steel	0,37	.015	J
	0,50	.020	K
	0,80	.032	L
German Silver	0,08	.003	O
Flat Steel	0,90 x 0,50	.035 x .020	T
Galvanised Steel	0,43	.017	S
Laminated Wire	3 x 0,20 + 6 x 0,35	3 x .008 + 6 x .014	W
	0,50	.020	Y



CONVERSION TABLE mm / Inches

Ø Brush	mm		Ø Wire		I.S.W.G
	mm	Inches	mm	Inches	
25		1"	0,08	0,003"	44
50,8		2"	0,1	0,004"	42
76,2		3"	0,12	0,005"	40
101,6		4"	0,15	0,006"	38
127		5"	0,2	0,008"	36
152,4		6"	0,25	0,01"	33
177,8		7"	0,3	0,0118"	31
203,2		8"	0,35	0,0138"	29
228,6		9"	0,4	0,016"	27
254		10"	0,5	0,02"	25
279,4		11"	0,8	0,0315"	21

Material Information

TECHNICAL INFORMATION



Brass Coated Steel

High Performance and flexibility.
Anti-corrosion material.
Suitable for a large range of finishing.

Traction resistance 230-250 Kgs/mm².
Carbon content 0,75%.

Available thickness (mm): 0,15 - 0,20 - 0,25
- 0,30 - 0,35 - 0,40 - 0,50.

We have the following cable crimped wire
range: 6x0,23 - 12x0,23 - (3x0,20)+(6x0,35).



Brass

Anti-sparking wires.
Suitable for soft finishing in non-ferrous
materials.

Traction resistance 80-95 Kgs/mm².
Available thickness (mm): 0,08 - 0,30 - 0,40.



Cable Crimped Wire. High Performance

High Performance brushes are made
of cable wire, made of a bunch of
high strength brass coated steel
wires, which form a flexible and
compact unit. You get a type of
finishing and extraction capacity
similar to monofilament of 0.30
mm.

They provide important advantages:
Performance: 50% longer lifetime
due to their greater resistance to
fatigue.
Flexibility: Better adaptation to
irregular surfaces.

Security: It avoids broken chunks.



Laminated Wire Brush

The laminated wire is a novelty in
the metal brushware industry and
it provides an element of comfort
and security to the handling of
wire brushes. The coating of the
wires prevents from being wounded
too.

It provides a high performance
as a result of the reduced level of
breakings of the laminated wires
compared to an equivalent wire
uncoated.



Grey Steel

Suitable for twist-knotted brushes
and a high removal capacity.

Non suitable for stainless steel
surfaces.

Traction resistance 200-275
Kgs/mm².
Carbon content 0,50-0,60%.

Available thickness (mm): 0,12 - 0,20 - 0,30
- 0,37 - 0,50 - 0,80.

We have 0,10 mm Bessemer wire.

Material Information

TECHNICAL INFORMATION



Stainless Steel

These wires are used for the brushing of stainless steel, aluminium or non ferrous metal surfaces.

Stainless steel turned into wire becomes lightly magnetic.

Traction resistance 160-180 Kgs/mm² following AISI 304-L regulations.

Available thickness (mm): 0,15 - 0,20 - 0,30 - 0,40 - 0,50.

We have stainless steel wire following AISI 3016-L regulations and stainless steel cable 7x0,35.



German Silver

Suitable for soft polishing in silver colour surfaces.

Copper content 60-65%, Zinc 22-25% and Nickel 11-13%.

Available thickness: 0,08 mm.



Abrasive Nylon

Abrasive nylon trims regenerate constantly and offer a uniform finishing during its lifetime.

We have 2 sorts of filaments:

Nylon 6-12 with silicon carbide grains for industrial applications and with 120,180 and 320 grains.

Nylon 6 with aluminium oxide for DIY and with 80 and 150 grains.



Street Cleaning Materials

All of them are manufactured with steel filaments, fibres or a mixture of both materials

Laminated steel permits an excellent brushing in sand and ground pavements. This filament is available in 2 width (2x0,6 and 3,30x0,6 mm) and in 2 length (540 and 600 mm). Crimped steel of 0,70 mm offers

a high performance brushing and avoids the marks and scratches in urban pavements.

We offer a large variety of plastic fiber brushes (PLP, Polyester PET, Polyester PBT and Nylon 6.6) with different sections depending on the necessities of the customer.

Application Information

TECHNICAL INFORMATION



Please, consider the following criteria when selecting a brush:

To choose the kind of brush:

- The work to be done.
- Application surface.
- RPM parameters of the machine.

To decide on the type of material, wire or nylon abrasive:

- The material of the application surface.
- Desired Finishing.
- RPM parameters for machine.

Work efficiency increases as a brush diameter increases. To calculate the biggest possible diameter, it is necessary to consider the maximum RPM of the power tool or machine being used (i.e. for an electric tool with maximum RPM of 6,000, the brush should not exceed 175 mm diameter). A shorter trim length provides a more aggressive brushing action, whereas flexibility to adapt to irregular or uneven surfaces increases as trim length increases.

In contrast to abrasives and cutting tools, wire brushes do not remove the base material of a treated surface. Herein, brushes serve as an essential tool for a wide range of industrial processes.

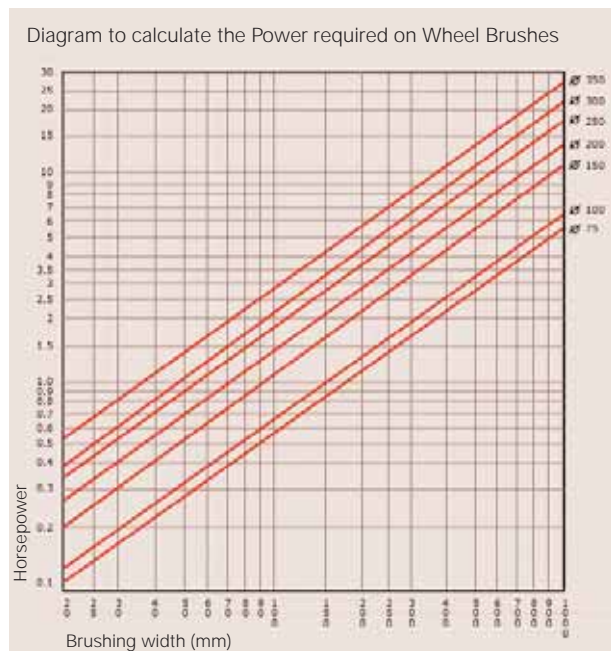

Application Information

TECHNICAL INFORMATION



Troubleshooting Guide

Several factors can influence a brush application. If the selected brush does not achieve the expected result, the following table may provide solutions for the most common problems faced by the user. For further information, please contact our Technical Department.

PROBLEM	SUGGESTED SOLUTIONS
Brush is too aggressive	Increase trim length. Decrease wire diameter. Work at lower speed.
Finish too coarse	Increase trim length. Decrease wire diameter. Choose a nylon abrasive brush.
Action of brush is not uniform	Decrease brushing pressure. Decrease wire diameter. Work at lower speed.
Life of the brush is too short	Decrease wire diameter. Increase brush diameter. Decrease brushing pressure.

Multithreads and Adapters

The exclusive and patented JAZ threaded nut provides for a number of advantages:

- Easier tightening into machines.
- Higher resistance of the brush against possible deformation.
- The multithread option allows the use of one brush on machines with different types of spindle:
 - R88 threaded nut: fits both 5/8-11" and M14-2 machines.
 - R77 threaded nut: fits both M10x1,25 and M10x1,5.

The purpose of these innovations is to help distributors better manage the line by reducing the number of SKU-s or items and improve their level of service to their customers and end users.



W-5/8"



M14

Multi-thread adapters: JAZ is offering a variety of thread adapter options from 5/8-11" nuts:

- ADP. W5/8-F10: adapter to M10x1,25.
- ADP. W5/8-M10: adapter to M10x1,5.
- ADP. W5/8-U38: adapter to 3/8"-24.
- ADP. W5/8-R77: multi-adapter to both M10x1,25 and M10x1,5.

This last option, when used in conjunction with an R88 thread, can substitute 4 different thread options.



Technical Brushing

TECHNICAL INFORMATION

From our Technical Department we offer brushing solutions for different industrial processes and needs posed by the different sectors which demand customized products and rely on our experience gained over our history of more than 90 years dedicated to the brushware industry.

Manufacturing of technical brushes requires direct collaboration between manufacturer and user. In JAZ ZUBIAURRE S.A. we have specialized personnel and appropriate technical resources, for answering your queries and provide the best solution to your request. We offer a complete service that covers the definition of form and materials, making necessary tooling (shafts or rotors), end user training and even automatization the process of brushing. Knowledge of the different wires and materials is very important in defining the ideal brush for each requirement. JAZ offers high resistance steel wire between 0.08 and 0.80 mm., Stainless steel wires, brass, nickel silver, nylon abrasives,. We also offer high performance steel and stainless steel. JAZ can also supply brushes with different arbor holes: plain hole or with keyway .

Sectors

The sectors we serve are very diverse. Among them are the following:

- Construction
- Tube deburring
- Rubber - Metal Injection
- Packaging
- Cleaning of continuous saws
- Treatment in stone
- Wood Texturing
- Food industry
- Turning
- Rod cleaning
- Retreading
- Mold cleaning
- Automotive parts deburring
- ...



CT-1507E

MADE IN
SPAIN

PROTEJA SUS OJOS
WEAR EYE PROTECTION

6500
MAX. RPM

ACERO
STEEL



Ø 150x25x0.30 mm
Ø 6" x 1" x .072"

/ 02

Wire Brushes



2.1

CRIMPED WIRE WHEELS

CT Wide Face Wheel

WIRE BRUSHES / CRIMPED WIRE WHEELS

See construction drawing on page 84



Diameter (d)	No. of Rows	Face Width (a)		Trim Length (s)		Multi Thread (e)	Coated Steel				Stainless Steel			Brass	R.P.M. Max.	
		mm	"	mm	"		mm	"	0,20 mm .008"	0,30 mm .012"	0,40 mm .016"	0,50 mm .020"	0,20 mm .008"			0,30 mm .012"
50	2"	4	14	9/16"	9	3/8"	10	3/8"	0504C	0504E	0504G	0504H	0504N	0504Z	0504V	12.000
		5	15	5/8"					0505C	0505E	0505G	0505H	0505N	0505Z	0505V	
75	3"	4	14	9/16"	22	7/8"	13	1/2"	0704C	0704E	0704G	0704H	0704N	0704Z	0704V	12.000
		5	16	5/8"					0705C	0705E	0705G	0705H	0705N	0705Z	0705V	
100	4"	3	12	1/2"	18	11/16"	16	5/8"	1003C	1003E	1003G	1003H	1003N	1003Z	1003V	6.500
		4	14	9/16"					1004C	1004E	1004G	1004H	1004N	1004Z	1004V	
		5	16	5/8"					1005C	1005E	1005G	1005H	1005N	1005Z	1005V	
		7	22	7/8"					1007C	1007E	1007G	1007H	1007N	1007Z	1007V	
125	5"	3	13	1/2"	30	1.5/32"	22	7/8"	1203C	1203E	1203G	1203H	1203N	1203Z	1203V	6.500
		4	15	5/8"					1204C	1204E	1204G	1204H	1204N	1204Z	1204V	
		5	19	3/4"					1205C	1205E	1205G	1205H	1205N	1205Z	1205V	
		7	25	1"					1207C	1207E	1207G	1207H	1207N	1207Z	1207V	
150	6"	4	15	5/8"	28	1.1/8"	13	1/2"	1504C	1504E	1504G	1504H	1504N	1504Z	1504V	6.500
		5	20	3/4"					1505C	1505E	1505G	1505H	1505N	1505Z	1505V	
		7	25	1"					1507C	1507E	1507G	1507H	1507N	1507Z	1507V	
		9	32	1.1/4"					1509C	1509E	1509G	1509H	1509N	1509Z	1509V	
175	7"	4	17	11/16"	40	1.5/8"	16	5/8"	1704C	1704E	1704G	1704H	1704N	1704Z	1704V	6.500
		5	20	3/4"					1705C	1705E	1705G	1705H	1705N	1705Z	1705V	
		7	27	1.1/16"					1707C	1707E	1707G	1707H	1707N	1707Z	1707V	
		9	32	1.1/4"					1709C	1709E	1709G	1709H	1709N	1709Z	1709V	
200	8"	4	17	11/16"	40	1.5/8"	26	1"	2004C	2004E	2004G	2004H	2004N	2004Z	2004V	4.500
		5	20	3/4"					2005C	2005E	2005G	2005H	2005N	2005Z	2005V	
		6	25	1"					2006C	2006E	2006G	2006H	2006N	2006Z	2006V	
		7	27	1.1/16"					2007C	2007E	2007G	2007H	2007N	2007Z	2007V	
225	9"	4	19	3/4"	53	2.1/16"	35	1.3/8"	2009C	2009E	2009G	2009H	2009N	2009Z	2009V	3.600
		5	22	7/8"					2204C	2204E	2204G	2204H	2204N	2204Z	2204V	
		6	27	1.1/16"					2205C	2205E	2205G	2205H	2205N	2205Z	2205V	
		7	29	1.1/8"					2206C	2206E	2206G	2206H	2206N	2206Z	2206V	
225	9"	7	29	1.1/8"	53	2.1/16"	36	1.3/8"	2207C	2207E	2207G	2207H	2207N	2207Z	2207V	3.600
		9	35	1.3/8"					2209C	2209E	2209G	2209H	2209N	2209Z	2209V	

Diameter (d)		No. of Rows	Face Width (a)		Trim Length (s)		Multi Thread (e)		Coated Steel				Stainless Steel			Brass	R.P.M. Max.
mm	"		mm	"	mm	"	mm	"	0,20 mm .008"	0,30 mm .012"	0,40 mm .016"	0,50 mm .020"	0,20 mm .008"	0,30 mm .012"	0,30 mm .012"		
250	10"	4	22	7/8"	65	2.5/8"	13	1/2"	2504C	2504E	2504G	2504H	2504N	2504Z	2504V	3.600	
		5	25	1"					2505C	2505E	2505G	2505H	2505N	2505Z	2505V		
		6	28	1.1/8"					2506C	2506E	2506G	2506H	2506N	2506Z	2506V		
		7	35	1.3/8"					2507C	2507E	2507G	2507H	2507N	2507Z	2507V		
		9	39	1.1/2"					2509C	2509E	2509G	2509H	2509N	2509Z	2509V		
300	12"	4	22	7/8"	90	3.5/8"	22	7/8"	3004C	3004E	3004G	3004H	3004N	3004Z	3004V	3.000	
		5	25	1"					3005C	3005E	3005G	3005H	3005N	3005Z	3005V		
		6	29	1.3/4"					3006C	3006E	3006G	3006H	3006N	3006Z	3006V		
		7	35	1.3/8"					3007C	3007E	3007G	3007H	3007N	3007Z	3007V		
		9	39	1.1/2"					3009C	3009E	3009G	3009H	3009N	3009Z	3009V		
350	14"	4	23	7/8"	115	4.5/8"	36	1.3/8"	3504C	3504E	3504G	3504H	3504N	3504Z	3504V	2.400	
		5	27	1.1/16"					3505C	3505E	3505G	3505H	3505N	3505Z	3505V		
		6	31	1.1/4"					3506C	3506E	3506G	3506H	3506N	3506Z	3506V		
		7	38	1.1/2"					3507C	3507E	3507G	3507H	3507N	3507Z	3507V		
		9	41	1.5/8"					3509C	3509E	3509G	3509H	3509N	3509Z	3509V		

Note: Face width measures are always approximate. Brushes made on request will indicate all necessary specifications on the side plates.

CT Wide Face Wheel with Multi-Fitting Adaptor

WIRE BRUSHES / CRIMPED WIRE WHEELS

Multi threaded Nut

- Code 99.
- Ø: 13-16-20-22-26-30-50 mm.
- Enables to use different bore diameters, and this way we reduce the stock.



Technical Information CT

- They are designed for individual tasks with wide possibilities in dimensions, arbor holes and wires.

Applications CT

- Removal of rust, paint, scale, edges, etc.
- Cleaning of forged pieces. Tyre recovery.
- Surface processing in metal, rubber, plastic, wood, glass, etc.



CT With Threaded Nut

WIRE BRUSHES / CRIMPED WIRE WHEELS



We are presenting a range of 5 row, 0,30 mm. steel wire brushes (diam 150, 175 and 200 mm.) that incorporate a threaded nut. This simplifies the attachment of the brush to threaded spindle machines (i.e. portable machines).

Available in different wires and threads.

Code: CT 1505E M14
 CT 1705E M14
 CT 2005E M14



CT brush models are presented with our exclusive new security handling system.



CU Narrow Face Wheel 3 Rows – Face Width of 11 mm (7/16")

WIRE BRUSHES / CRIMPED WIRE WHEELS



Diameter (d)	Trim Length (s)	Coated Steel				Stainless Steel		Brass	R.P.M. Max.
		0,15 mm .006"	0,20 mm .008"	0,30 mm .012"	0,40 mm .016"	0,20 mm .008"	0,30 mm .012"		
100 4"	20 3/4"	1003B	1003C	1003E	1003G	1003N	1003Z	1003V	6.000
125 5"	23 7/8"	1203B	1203C	1203E	1203G	1203N	1203Z	1203V	6.000
150 6"	28 1.1/8"	1503B	1503C	1503E	1503G	1503N	1503Z	1503V	6.000
175 7"	40 1.5/8"	1703B	1703C	1703E	1703G	1703N	1703Z	1703V	6.000
200 8"	53 2.1/16"	2003B	2003C	2003E	2003G	2003N	2003Z	2003V	4.500
225 9"	49 2"	2203B	2203C	2203E	2203G	2203N	2203Z	2203V	3.600
250 10"	61 2.3/8"	2503B	2503C	2503E	2503G	2503N	2503Z	2503V	3.600
300 12"	86 3.3/8"	3003B	3003C	3003E	3003G	3003N	3003Z	3003V	3.000

Note: R.P.M. specifications vary when several brushes are put together in a roller.
We have drive shafts with keyways. You can make us an enquiry.

Axis description

Brush Diameter	100 - 125 mm 4" - 5"	150-175-200 mm 6"-7"-8"	225-250-300 mm 9"-10"-12"
Fixed Arbor Hole (e)	13-16-20-26 mm 1/2"-5/8"-3/4"-1"	13-16-20-22-26-30-35-36-40-50-50,8mm 1/2"-5/8"-3/4"-7/8"-1"-1.3/16"-1.3/8"-1.5/8"-2"	16-20-22-26-30-36-40-50-50,8mm 5/8"-3/4"-7/8"-1"-1.3/16"-1.3/8"-1.5/8"-2"



- The CU brushes are mounted as shown in the photo.
- Must be taken into account that at each end of each block must be placed side plates of the same diameter of the CU brush plates.
- The thickness of the plate should be prepared taking into account the application, r.p.m., etc.

CU Narrow Face Wheel 4 Rows – Face Width of 13 mm (1/2")

WIRE BRUSHES / CRIMPED WIRE WHEELS



Diameter (d)	Trim Length (s)	Coated Steel					Stainless Steel		Brass	R.P.M. max.
		0,15mm .006"	0,20mm .008"	0,30mm .012"	0,40mm .016"	0,5mm .020"	0,20mm .008"	0,3mm .012"		
250 10"	25 1"	92504B	92504C	92504E	92504G	92504H	92504N	92504Z	92504V	3.600
275 11"	47,5 2"	92754B	92754C	92754E	92754G	92754H	92754N	92754Z	92754V	3.600
300 12"	60 2,3/8"	93004B	93004C	93004E	93004G	93004H	93004N	93004Z	93004V	3.600
325 13"	72,5 3"	93254B	93254C	93254E	93254G	93254H	93254N	93254Z	93254V	3.600
350 14"	85 3.1/4"	93504B	93504C	93504E	93504G	93504H	93504N	93504Z	93504V	3.000
400 16"	110 4.11/32"	94004B	94004C	94004E	94004G	94004H	94004N	94004Z	94004V	3.000

Note: R.P.M. specifications vary when several brushes are put together in a roller.
We have drive shafts with keyways. You can make us an enquiry.

Axis description

Brush Diameter	250 - 400 mm 10" - 16"
Fixed Arbor Hole (e)	50,8-80-82,55-110 2"-3.1/8"- 3.1/4"-4.11/32"

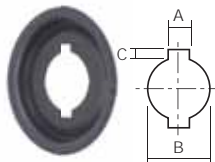

Diameter (B)	INSIDE DIAMETER with keyways		KEYway (A)	KEYway (C)		Code
	mm	"		mm	"	
50,8	2"	13	1/2"	7	9/32"	51
54,7	2.5/32"	13	1/2"	6	1/4"	55
80	3.1/8"	22	7/8"	5,5	1/4"	80
82,55	3.1/4"	22	7/8"	7	9/32"	83
110	4.11/32"					110



order example:
CU 1503E 16
1. Model: **CU**
2. Article Code: **1503**
3. Wire Code: **E**
4. Arbor Hole: **16 mm**

Technical Information CU

- Specially designed for making rollers by joining individual brushes.
- Special models are available for rollers of large dimension and the possibility of arbor holes with dragging keys.
- Individually used, they are appropriate for brushing narrow places.

Applications CU

- Removal of rust, paint and scale.
- Edge cleaning of tubes and sections, manually or automatically (R.S.A, ADIGE, etc. machine types).

CCA Cable Crimped High Performance

WIRE BRUSHES / CRIMPED WIRE WHEELS



Outside Diameter mm	(d) "	Rows	Face Width (a)		Trim Length (s)		Body axis/ multi-axis	Cable Coated Steel 0,35mm	————— 0,23mm	R.P.M. Max.
			mm	"	mm	"				
150	6"	5	20	3/4"	28	1.1/8"	13-1/2", 16-5/8", 20-3/4", 22,3-7/8", 25-1", 26-1", 30-1.3/16", 32-1.1/4", 35-1.3/8", 36-1.3/8", 40-1.5/8", 50 50,8-2"	1505@	1505#	6.500
150	6"	9	32	1.1/4"				1509@	1509#	6.500
175	7"	5	20	3/4"	40	1.5/8"		1705@	1705#	6.500
175	7"	9	32	1.1/4"				1705@	1705#	6.500
200	8"	5	20	3/4"	40	1.5/8"		2005@	2005#	4.500
200	8"	9	35	1.3/8"				2009@	2009#	4.500
225	9"	5	22	7/8"	53	2.1/16"		2205@	2205#	4.500
225	9"	9	35	1.3/8"				2209@	2209#	4.500
250	10"	5	25	1"	65	2.5/8"		2505@	2505#	4.500
250	10"	9	39	1.1/2"				2509@	2509#	4.500

Technical Information CCA

- In these brushes traditional individual crimped wires (monofilaments) are substituted by several wires making cable crimped wire. These cable crimped wires are made by groups of 0,23 and 0,35 mm diameter high resistance steel wires, making a flexible, compact and aggressive brush.
- The type of finishing and removal capacity is medium. The cable wire 0,35 mm has a similar finishing of the wire 0,30 mm and the cable of 0,23 mm has a similar finishing of the 0,20 mm wire.

Applications CCA

- Removal of rust, paint, scale and dirt.
- Cleaning of castings.
- Treating metallic surfaces, rubber, plastic, wood or glass
- Metallic construction, ship-building, boiler industry, stone and concrete

order example:
CCA 1505@99
 1. Model: **CCA**
 2. Article Code: **1505@**
 3. Arbor Hole: **99**

G Jewelry Wheel With Wooden Center

WIRE BRUSHES / CRIMPED WIRE WHEELS



Diameter (d)		No. of Rows	Face Width (a)		Trim Length (s)		Arbor Hole (e)		Brass	G. Silver	Bessemer	R.P.M. Recom.
mm	"		mm	"	mm	"	mm	"	0,08 mm .003"	0,08 mm .003"	0,10 mm .004"	
80	3.1/4"	4	15	5/8"	20	3/4"	6	1/4"	0804U	08040	0804R	700
80	3.1/4"	5	16	5/8"	20	3/4"	6	1/4"	0805U	08050	0805R	700
80	3.1/4"	6	17	11/16"	20	3/4"	6	1/4"	0806U	08060	0806R	700
100	4"	4	18	11/16"	30	1.3/16"	6	1/4"	1004U	10040	1004R	600
100	4"	5	20	3/4"	30	1.3/16"	6	1/4"	1005U	10050	1005R	600
100	4"	6	22	7/8"	30	1.3/16"	6	1/4"	1006U	10060	1006R	600
120	4.3/4"	4	22	7/8"	35	1.3/8"	6	1/4"	1204U	12040	1204R	500
120	4.3/4"	5	24	15/16"	35	1.3/8"	6	1/4"	1205U	12050	1205R	500
120	4.3/4"	6	28	1.1/8"	35	1.3/8"	6	1/4"	1206U	12060	1206R	500
150	6"	4	26	1"	50	2"	9	3/8"	1504U	15040	1504R	380
150	6"	5	30	1.3/16"	50	2"	9	3/8"	1505U	15050	1505R	380
150	6"	6	34	1.3/8"	50	2"	9	3/8"	1506U	15060	1506R	380

Technical Information

- Special model for very fine polishing.
- Wooden center to avoid material damage.
- Brass: for gold plated metallic surfaces.
- German Silver: for silver plated surfaces.

Applications

- Jewelry, silver plating, etc.
- Dental fitting.
- Galvanizing processes. Polishing of oxidized surfaces.

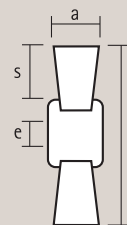

order example:
G 1204U
 1. Model: **G**
 2. Article Code : **1204U**

CDO Industrial Wheel with hole

WIRE BRUSHES / CRIMPED WIRE WHEELS



Technical Specifications

- Arbor hole diameter: 6 - 8 - 10mm

Applications

- The CDO brush range are mainly used for wire stripping, key duplicating, continuous saws, etc.
 - The brush separates the plastic from copper.
 - CDOs are made depending on the specifications of each
- It is necessary to define:
 - Outside Diameter.
 - Width.
 - Bore.
 - Wire diameter.
 - Grit size of the abrasive nylon.

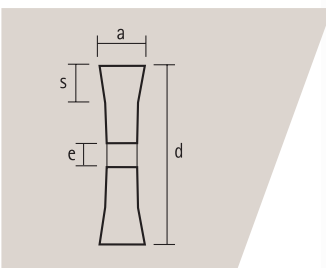

2.2

BRUSHES FOR DEBURRING MACHINES

CT & CCA Brushes - High Density

WIRE BRUSHES / BRUSHES FOR DEBURRING MACHINES



Outside Diameter(d) mm "	Rows	Face Width (a) mm "	Trim Length (s) mm "	BRUSH CT Monofilament wire						BRUSH CCA Cable wire		R.P.M. Max.
				Coated Steel			Stainless			Cable crimped CCA	Cable stainless steel	
				0,20mm .008 Pulg.	0,30mm .012 Pulg.	0,50mm .020 Pulg.	0,20mm .008 Pulg.	0,30mm .012 Pulg.	0,50mm .020 Pulg.			
250 10"	16	60 2.3/8"	45 1.3/4"	2516C	2516E	2516H	2516N	2516Z	2516Q	2616@	2616@Z	3.600
250 10"	28	95 3.3/8"	45 1.3/4"	2528C	2528E	2528H	2528N	2528Z	2528Q	2528@	2528@Z	3.600
300 12"	14	60 2.3/8"	50 2"	3014C	3014E	3014H	3014N	3014Z	3014Q	3014@	3014@Z	3.000
300 12"	25	95 3.3/8"	50 2"	3028C	3028E	3028H	3028N	3028Z	3028Q	3028@	3028@Z	3.000

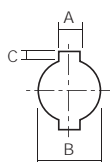

INSIDE DIAMETER with keyways							PLAIN INNER DIAMETER		
Diameter (B) mm "	Keyway (A) mm "	Keyway (C) mm "	Code		Diameter (B) mm "	Code			
50,8 2"	13,2 1/2"	7,1 9/32"	C51		25,4 1"	C26			
52,9 2.3/32"	13,5 1/2"	6,4 1/4"	C53		100 4"	C100			
54,7 2"	13,6 1/2"	5,8 1/4"	C55		110 4.11/32"	C110			
80 3.1/8"	13,5 1/2"	7,5 9/32"	C80						
82,55 3.1/4"	13,5 1/2"	6,4 1/4"	C82						

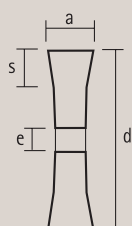

order example:
CT 3014EC51
 1.Model: **CT**
 2.Code: **3014E**
 3.Arbor Hole: **C51**

Technical Specifications

- These brushes are typically used for deburring tube ends and profiles.
- These brushes are mainly characterized by its high density, quality and perfect balance.

CUCB Roller Brushes

WIRE BRUSHES / BRUSHES FOR DEBURRING MACHINES

See construction drawing on page 85



Outside Diameter(d)	Face Width (a)	Trim Length (s)	Coated Steel		Cable crimped	Stainless		Cable stainless steel	R.P.M. Max.			
			0,20mm .008"	0,50mm .020"		0,20mm .008"	0,50mm .020"					
250	10"	300	12"	35	1,3/8"	CUCB92524C	CUCB92524H	CUCB92524@	CUCB92524N	CUCB92524Q	CUCB92524@Z	3.600
250	10"	450	18"	35	1,3/8"	CUCB92536C	CUCB92536H	CUCB92536@	CUCB92536N	CUCB92536Q	CUCB92536@Z	3.600
250	10"	600	24"	35	1,3/8"	CUCB92548C	CUCB92548H	CUCB92548@	CUCB92548N	CUCB92548Q	CUCB92548@Z	3.600
300	12"	300	12"	60	2,3/8"	CUCB93024C	CUCB93024H	CUCB93024@	CUCB93024N	CUCB93024Q	CUCB93024@Z	3.600
300	12"	450	18"	60	2,3/8"	CUCB93036C	CUCB93036H	CUCB93037@	CUCB93036N	CUCB93036Q	CUCB93037@Z	3.600
300	12"	600	24"	60	2,3/8"	CUCB93048C	CUCB93048H	CUCB93048@	CUCB93048N	CUCB93048Q	CUCB93048@Z	3.600

Inside diameter type	C51	C80	C83	C110
Keyway (mm)	50,8X12,70X6,35	80X22X5,5	82,55X22X7	110
Keyway (")	2"x1/2"x1/4"	3.1/8"x 7/8"x1/4"	3.1/4"x7/8"x1/4"	4.11/32"
Plain	ØxAxB	ØxAxB	ØxAxB	Ø

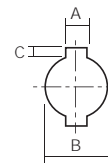

Technical Specifications

- Wire brushes manufactured in a block of high density and a perfect balance.
- The CUCB brushes suit the main deburring machines in the market.

Applications

- Deburring of tube and profiles cut ends.
- Mainly for automatic deburring machines ADIGE type-RSA-Pedrazzoli etc. Burmaster

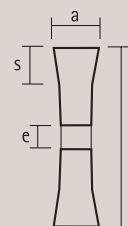
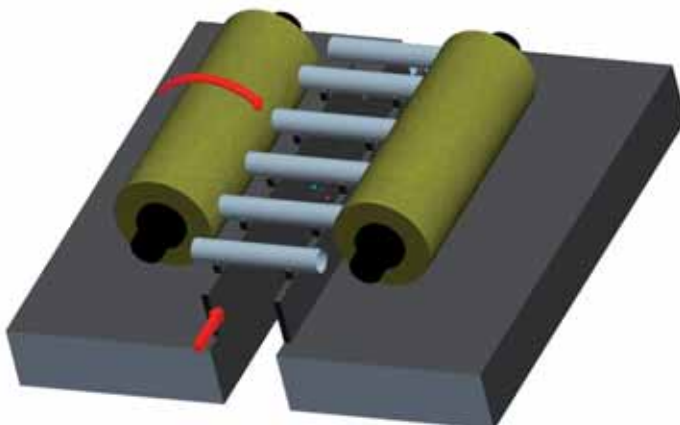

order example:
CUCB 93037@C80
 1.Model:**CUCB**
 2.Code:**93037@**
 3.Inside diameter:**C80**

BCSE End Brushes without shank

WIRE BRUSHES / BRUSHES FOR DEBURRING MACHINES



Model	D		T		L		Pack	Coated Steel		Stainless		Abrasive Nylon	
	mm	"	mm	"	mm	"		0,20 mm .008"	0,50 mm .020"	0,20 mm .008"	0,50 mm .020"	Grit 120	Grit 180
BC	25	1"	95	3.74"	25	1"	16	92656CSE	921696HSE	92696NSE	92696QSE	92696120SE	92696180SE

Features and Applications

- End brushes which are mounted on tools of 8, 16 and 24 units.
- For use in manual and automatic machines for deburring of tubes, profiles.

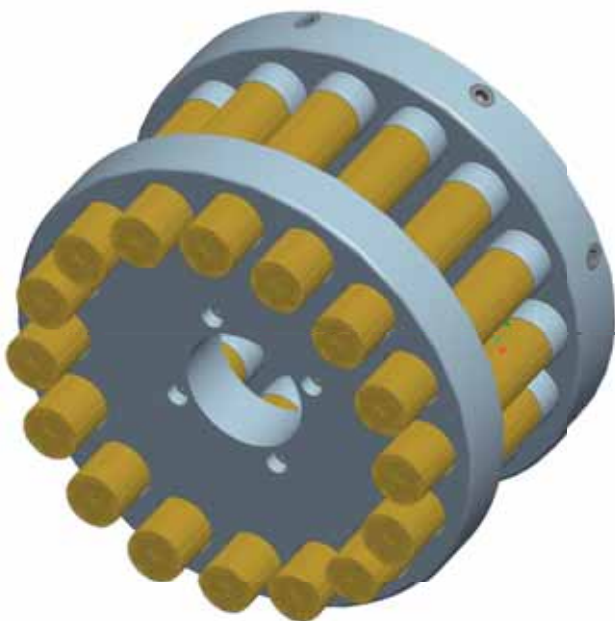

order example:
BC92656CSE
1.Model:BC
2.Code:92656CSE

2.3

TWIST KNOT WHEELS

CAM Twist Knot Wheel Knot of 12 mm (1/2")

WIRE BRUSHES / TWIST KNOT WHEELS



Outside Diameter (d) mm/inches	No. of Knots	Knot Width (a) mm/inches	Trim Length (s) mm/inches	Arbor / Hole (e)	Grey Steel			Stainless 0,50 mm .020"	Brass 0,40 mm .016"	R.P.M. Max.	
					0,37 mm .015"	0,50 mm .020"	0,80 mm .032"				
80	3.1/4"	20	10 3/8"	16 5/8"	10, 13; 3/8", 1/2"	0801J	0801K	0801L	0801Q	0801X	20,000
100	4"	20	12 1/2"	19 3/4"	16-22	1001J	1001K	1001L	1001Q	1001X	15,000
115	4.1/2"	20	12 1/2"	26 1"	5/8"-7/8"	91151J	91151K	91151L	91151Q	91151X	12,000
125	5"	22	12 1/2"	26 1"	M14 W5/8"	1201J	1201K	1201L	1201Q	1201X	12,000
150	6"	24	12 1/2"	34 1.3/8"	5/8" UNC	71501J	71501K	71501L	71501Q	71501X	9,000
175	7"	24	12 1/2"	46 1.3/4"	Multi R (1)	71701J	71701K	71701L	71701Q	71701X	8,500
200	8"	40	12 1/2"	29 1.1/8"	(2)	2001J	2001K	2001L	2001Q	2001X	4,500
250	10"	40	12 1/2"	54 2.1/8"	(2)	2501J	2501K	2501L	2501Q	2501X	4,500
250	10"	56	12 1/2"	38 1.1/2"	(3)	9251J	9251K	9251L	9251Q	9251X	3,600
300	12"	56	12 1/2"	63 2.1/2"	(3)	3001J	3001K	3001L	3001Q	3001X	3,600
350	14"	56	12 1/2"	88 3.1/2"	(3)	3501J	3501K	3501L	3501Q	3501X	3,600

(1) Exclusive design for M14x2 and 5/8"-11 (Code R88) or for M10x1,25 and M10x1,50 (Code R77)



Available in different types of rows and diameters.

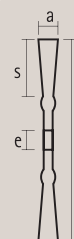

order example:
CAM 2001 K22
 1. Model: **CAM**
 2. Article Code: **2001K**
 3. Arbor Hole: **22**

(2) PLAIN BORE		(3) INSIDE DIAMETER WITH KEYWAYS					
Diameter (B)	"	Key way (B)		Key way (A)		Key way (C)	
mm	"	mm	"	mm	"	mm	"
20	3/4"	31,75		8	1/3"	4	1/6"
22	7/8"	50,8	2	13,2	1/2"	7,1	9/32"
25,4	1"	52,9	2.3/32"	13,5	1/2"	6,4	1/4"
30	1.3/16"	54,7	2	13,6	1/2"	5,8	1/4"
36	1.3/8"	80,2	3.1/8"	13,5	1/2"	7,5	9/32"
40	1.5/8"	82	3.1/4"	13,5	1/2"	6,4	1/4"
50							
50,8	2"						
100	4"						
110	4.11/32"						

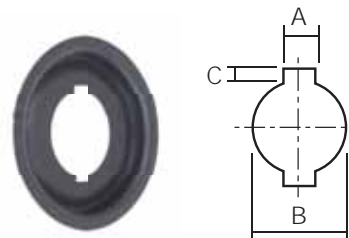

CAM Twisted Knot Wheel Agressive 10 mm (1/2 ")

WIRE BRUSHES / TWIST KNOT WHEELS

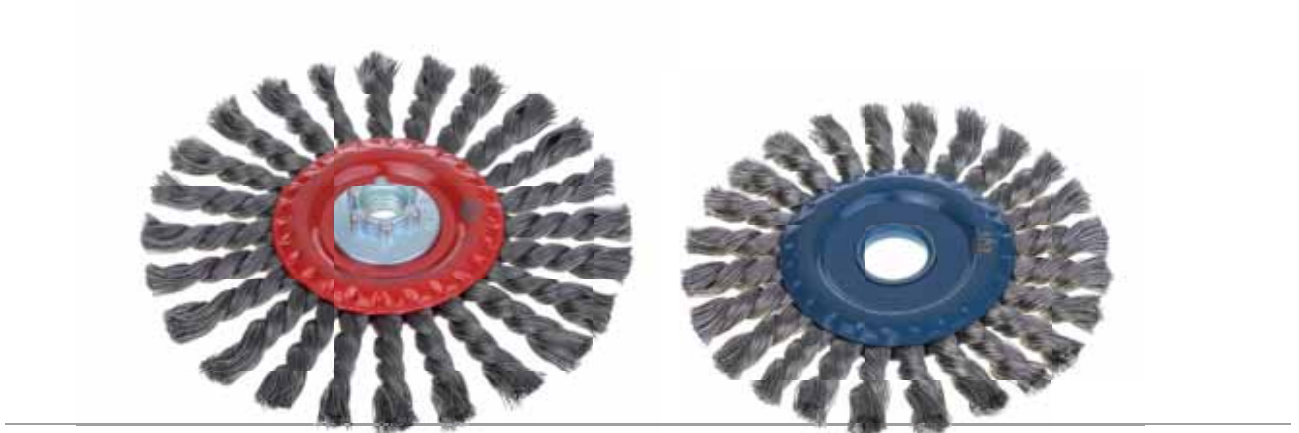

Outside diameter (d) mm	No. of Knots "	Knot Width (a) mm	Trim Length (s) mm	Arbor / Hole (e)	Grey Steel 0,50 mm .020"	Stainless 0,50 mm .020"	Brass 0,40 mm .016"	R.P.M. Max	
150	6"	24	10 3/8"	34 1,3/8"	13-16-22 (1/2"-5/8"-7/8")	1501K	1501Q	1501X	9,000
175	7"	24	10 3/8"	46 1,3/4"	M14 W5/8" UNC Multi R (1)	1701K	1701Q	1701X	8,500

(1) Exclusive design for M14x2 and 5/8"-11 (Code R88) or for M10x1,25 and M10x1,50 (Code R77)

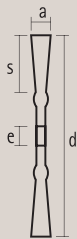

order example:
CAM 1501K 16
1. Model: CAM
2. Article Code: 1501K
3. Arbor Hole: 16



Technical Information

- The twist knot wire allows:
 - Long working life.
 - High removal capacity.
 - Possibility of working at high speed.
- Exclusive design and patented multifitting thread in two different versions; one is valid for M14 and 5/8-11 attachments (Code R88); the other is valid for M10 x 1,5 and M10 x 1,25 systems (Code R77).
- The new design is also extended to single threads. It allows an easier attachment and increases resistance resulting in more safety for the user.

Applications

- Removal of welding and forge scale. Weld cleaning at the tube joints in
- Tyre-rubber recovering and glass bottle recovering.



CAM Twisted Knot Wheel for Joints Cracks

WIRE BRUSHES / TWIST KNOT WHEELS



Outside diameter (d)		No. of Knots	Knot Width (a)		Trim Length (s)		Thread (e)		Wire		R.P.M. Max	Code
mm	"		mm	"	mm	"	mm	"	mm	"		
305	12"	40	9,5	3/8"	80	3.1/8"	25,4	1"	0,8	.31"	6.000	CAM93051L254

Technical Information and Applications

- Brush made with wide and narrow knots. These brushes fit equipment for cutting concrete, which are used to define the joint cracks.
- The brush makes cleaning function across the joint cracks before putting the silicone.
- An application used in airports, bridges, etc ...



CA Twisted Knot Wheel Simple

WIRE BRUSHES / TWIST KNOT WHEELS



You can contact JAZ for measure requirements

Technical Information

- Twisted Knot wheel Brushes unassembled, are provided so that the end user, can mount them in packages of different widths.
- The CA Brush requires from reusable side plates so they can hold properly the brush.

Applications

- All those in which width measurements may vary.



CPL Pipe-Lines Knot of 6 mm (1/4")

WIRE BRUSHES / TWIST KNOT WHEELS



Diameter (d)		No. of Knots	Knot Width (a)		Trim Length (s)		Arbor Hole (e)	Grey Steel	Stainless St.	R.P.M. Max.
mm	"		mm	"	mm	"		0,50 mm .020"	0,50 mm .020"	
100	4"	32	6	1/4"	37	1.1/2"	16-22 5/8"-7/8" M14 W5/8" 5/8" UNC Multi R (1)	71060K	71060Q	20.000
115	4.1/2"	32	6	1/4"	50	2"		91151K	91151Q	15.000
125	5"	38	6	1/4"	40	1.5/8"		91251K	91251Q	12.500
150	6"	30	8	5/16"	34	1.3/8"		1580K	1580Q	9.000
150	6"	30	6	1/4"	34	1.3/8"		1560K	1560Q	9.000
150	6"	50	6	1/4"	29	1.9/64"		81565K	81565Q	9.000
175	7"	30	8	5/16"	46	1.13/16"		1780K	1780Q	8.500
175	7"	30	6	1/4"	46	1.13/16"		1760K	1760Q	8.500
175	7"	48	6	1/4"	41	1.5/8"		91748K	91748Q	8.500
175	7"	56	6	1/4"	28	1.1/8"		81756K	81756Q	9.000
175	7"	76	6	1/4"	28	1.1/8"	91776K	91776Q	9.000	

(1) Exclusive design for M14x2 and 5/8"-11 (Code R88) or for M10x1,25 and M10x1,50 (Code R77)

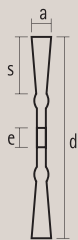

order example:
CPL 71060K W58
1. Model: **CPL**
2. Article Code: **71060K**
3. Arbor Hole: **W5/8**



Technical Information

- The twist knot wire allows:
 - Long working life.
 - High removal capacity.
 - Possibility of working at high speed.
- Exclusive design and patented multifitting thread in two different versions; one is valid for M14 and

5/8-11 attachments (Code R88); the other is valid for M10 x 1,5 and M10 x 1,25 systems (Code R77).

- The new design is also extended to single threads. It allows an easier attachment and increases resistance resulting in more safety for the user.

Applications

- Removal of welding and forge scale.
- Weld cleaning at the tube joints in PIPE-LINES (Mod. CPL).

2.4

CRIMPED CUP BRUSHES

TO Crimped Cup Brush Crimped Wire

WIRE BRUSHES / CRIMPED CUP BRUSHES



Diameter (d) mm	Trim Length (s)		Arbor Hole (e)	Coated Steel				Stainless		Brass	R.P.M. Max.
	mm	"		0,20 mm .008"	0,30 mm .012"	0,40 mm .016"	0,50 mm .020"	0,20 mm .008"	0,30 mm .012"	0,30 mm .012"	
60	2.3/8"	20 3/4"	(*)	0600C	0600E	0600G	0600H	0600N	0600Z	0600V	11.000
80	3.1/4"	30 1.3/16"	16-22 5/8"-7/8"	0800C	0800E	0800G	0800H	0600N	0800Z	0800V	8.500
100	4"	30 1.3/16"	M10-M14 W5/8"	1000C	1000E	1000G	1000H	1000N	1000Z	1000V	8.500
125	5"	30 1.3/16"	5/8" UNC	1250C	1250E	1250G	1250H	1250N	1250Z	1250V	8.500
150	6"	40 1.5/8"	Multi R (1)	1500C	1500E	1500G	1500H	1500N	1500Z	1500V	6.000

(*) Only available with threaded arbor hole.

(1) R88 Code: Multifitting for M14 and 5/8"-11; R77 Code: for M10 x 1,5 and M10 x 1,25.

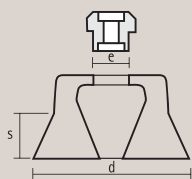

order example:
TO 1000E M14
 1. Model: **TO**
 2. Article Code: **1000E**
 3. Arbor Hole: **M14**



TCA Cable Crimped Wire High Performance Range

WIRE BRUSHES / CRIMPED CUP BRUSHES



Diameter (d)		Trim Length (s)		Bore Thread (e)	Cable Coated Steel	R.P.M. Max.
mm	"	mm	"			
100	4"	30	1.3/16"	M10-M14-W5/8"	1000@	8.500
125	5"	30	1.3/16"	Multi R (1)	1250@	8.500

(1) R88 Code: Multifitting for M14 and 5/8"-11; R77 Code: for M10 x 1,5 and M10 x 1,25.

Technical Information and Applications

- Specially designed for use on portable machines (angle grinders), electric or pneumatic.
- Appropriate for brushing large surfaces with a medium removal capacity.
- Fastening: plain bore or threaded arbor hole. We recommend threaded arbor hole because of their easier use and safety.
- Exclusive design and patented multifitting thread in two different versions: one is valid for M14 and 5/8- 11 attachments (Code R88); the other is valid for M10 x 1,5 and M10 x 1,25 systems (Code R77).
- Removal of rust, paint or any kind of adherence.
- Cleaning of castings.
- Treating metallic surfaces, rubber, plastic, wood or glass.
- Metallic construction, ship-building, boiler industry, stone and concrete.

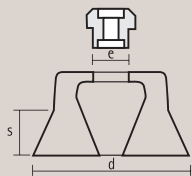

order example:
TCA 1000@ M14
 1. Model: **TCA**
 2. Article Code: **1000@**
 3. Arbor Hole: **M14**



2.5

TWIST KNOT CUP BRUSHES

TT Twist Knot Cup Brush Knotted Wire

WIRE BRUSHES / TWIST KNOT CUP BRUSHES



Diameter (d) mm	No. of Rows	Trim Length (s)		Arbor Hole (e)	Grey Steel			St. St.	Brass	R.P.M. Max.
		mm	"		0,37 mm .015"	0,50 mm .020"	0,80 mm .032"	0,50 mm .020"	0,40 mm .016"	
65	2.3/4"	1	20 3/4"	(*)	0601J	0601K	0601L	0601Q	0601X	15.000
80	3.1/4"	1	25 1"	16-22; 5/8"-7/8" M10-M14 W5/8"	0801J	0801K	0801L	0801Q	0801X	8.500
100	4"	1	27 1.1/8"		1001J	1001K	1001L	1001Q	1001X	8.500
125	5"	1	30 1.3/16"	5/8" UNC; Multi R (1)	1251J	1251K	1251L	1251Q	1251X	6.500
150	6"	1	35 1.3/8"		1501J	1501K	1501L	1501Q	1501X	6.000

(*) Only with thread: M10-M14-W 5/8"-5/8" UNC - Multi R.

(1) Exclusively designed threaded M14 x 2 and W5 / 8 "-11 (Code R-88) or M10 x 1.25 and M10 x 1.50 (Code R-77).

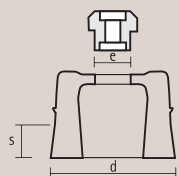

- order example:
TT 1001L M14
 1. Model: **TT**
 2. Article Code: **1001L**
 3. Arbor Hole: **M14**



The removal of the bridle can give more life to the tool



TT Twisted Knot Cup Brush 2 rows

WIRE BRUSHES / TWIST KNOT CUP BRUSHES



Diameter (d) mm	No. of Rows	Trim Length (s) mm	Arbor Hole (e)	Grey Steel			St. St.	Brass	R.P.M. Max.	
				0,37 mm .015"	0,50 mm .020"	0,80 mm .032"	0,50 mm .020"	0,40 mm .016"		
100	4"	2	27 1.1/16"	16-22; 5/8"-7/8"	1002J	1002K	1002L	1002Q	1002X	8500
125	5"	2	30 1.5/32"	M10-M14 W5/8"	1252J	1252K	1252L	1252Q	1252X	6500
150	6"	2	35 1.3/8"	5/8" UNC; Multi R (1)	1502J	1502K	1502L	1502Q	1502X	6000

TA Twisted Knot Cup Brush No Bridle

WIRE BRUSHES / TWIST KNOT CUP BRUSHES



Diameter (d) mm	No. of Rows	Trim Length (s) mm	Arbor Hole (e)	Steel		St. St.	R.P.M. Max.	
				0,50 mm .020"	0,80 mm .032"	0,50 mm .020"		
80	3.1/4"	1	23 7/8"	16-22; 5/8"-7/8"	90801K	90801L	90801Q	8500
100	4"	1	25 1"	M10-M14 W5/8"	91001K	91001L	91001Q	8500
125	5"	1	25 1"	5/8" UNC; Multi R (1)	91251K	91251L	91251Q	6500

(1) Exclusively designed threaded M14 x 2 and W5 / 8 "-11 (Code R-88) or M10 x 1.25 and M10 x 1.50 (Code R-77).

Technical Specifications

- The twisted wire gives these models:
 - Longer life.
 - Higher removal capacity.
 - Possibility to work at high speeds.
- Designed for use in portable machines.
- Suitable for brushing over large areas with a higher removal capacity.

- Exclusively designed threaded M14 x 2 and W5 / 8 "-11 (Code R-88) or M10 x 1.25 and M10 x 1.50 (Code R-77). Also valid to single thread. It allows an easier attachment and increases resistance.

Applications

- Cleaning and removal of welding scale, metallic structures, ship building, etc...

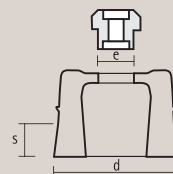

order example:
TA 90801KM14
 1. Model: **TA**
 2. Article Code: **90801K**
 3. Arbor Hole: **M14**

2.6

HIGH SPEED LINE BRUSHES

HS High Speed Brushes Crimped

WIRE BRUSHES / HIGH SPEED LINE BRUSHES



Model	Diameter (d)		Trim Length (s)		Arbor Hole (e)	Coated Steel	Stainless Steel	Coated Steel	R.P.M. Max.
	mm	"	mm	"		0,30 mm/0.012"	0,30 mm/0.012"	Crimped	
HSC	75	3"	22	7/8"	M14-M10	0075E	0075Z	0075@	13.000
HSD	85	3.3/8"	12	1/2"		0085E	0085Z		13.000
HSD	100	4"	24	1"	W5/8"-5/8" UNC	0100E	0100Z		13.000
HSP	115	4.1/2"	25	1"	Multi R (1)	0115E	0115Z		13.000
HCA	75	3"	22	7/8"					13.000

(1) Exclusive design for: M14 x 2 and 5/8"-11 (Code R88) or for M10 x 1,5 (R77 Code)

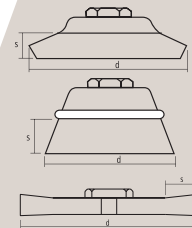

order example:
HSC 0075E M14
 1. Model: **HSC**
 2. Article Code: **0075E**
 3. Arbor Hole: **M14**



HS High Speed Brushes Knotted

WIRE BRUSHES / HIGH SPEED LINE BRUSHES



Model	Diameter (d)		Trim Length (s)		Arbor Hole (e)	Grey Steel	Stainless Steel	R.P.M. Max
	mm	"	mm	"		0,50 mm/.020"	0,50 mm/.020"	
HST	65	2.3/4"	20	3/4"	M14-M10	0065K	0065Q	15.000
HSK	100	4"	22	7/8"	W5/8"-5/8" UNC	0100K	0100Q	15.000
HSR	115	4.1/2"	26	1"	Multi R (1)	0115K	0115Q	13.000

(1) Exclusive design for: M14 x 2 and 5/8"-11 (Code R88) or for M10 x 1,5 (R77 Code)

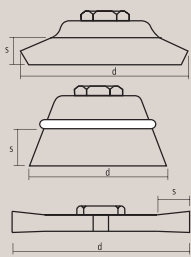

order example:
HST 0065K M14
 1. Model: **HST**
 2. Article Code: **0065K**
 3. Arbor Hole: **M14**



Technical Information HS

- JAZ High Speed Brushes have been specially designed for low weight and high speed mini-grinders (11,000 R.P.M.).
- High removal capacity and efficiency at high speed performance.
- Comfortable use and elimination of human fatigue.
- Special design allowing access to angles and flexible performance on any surface.

Applications

- For continuous and frequent brushing processes (ship building, metallic structures, welding, maintenance, etc.).
- Exclusive design and patented multifitting thread in two different versions; one is valid for M14 and 5/8- 11 attachments (Code R88); the other is valid for M10 x 1,5 and M10 x 1,25 systems (Code R77). The new design is also extended to single threads. It allows an easier attachment and increases resistance resulting in more safety for the user.



2.7

BRUSHES WITH PROTECTION GUARD

Cups with Protection Guard

WIRE BRUSHES / BRUSHES WITH PROTECTION GUARD



Model	Type of Wire	Diameter		Trim Length (s)		Thread	Coated Steel		Grey Steel		Stainless Steel		Cable Coated Steel	R.P.M. Max.
		mm	"	mm	"		0,30 mm .012"	0,50 mm .020"	0,50 mm .020"	0,80 mm .032"	0,30 mm .012"	0,50 mm .020"		
TOG	Crimped	80	3.1/4"	30	1.3/16"	M10-M14	0800E	0800H			0800Z			8.500
TOG	Crimped	100	4"	30	1.3/16"		1000E	1000H			1000Z			8.500
TOG	Crimped	125	5"	30	1.3/16"		1250E	1250H			1250Z			8.500
TTG	Twisted	80	3.1/4"	27	1.1/8"	W5/8"			0801K	0801L	0801Q			8.500
TTG	Twisted	100	4"	27	1.1/8"	Multi R (1)			1001K	1001L	1001Q			8.500
TTG	Twisted	125	5"	27	1.1/8"				1251K	1251L	1251Q			6.500
TCAG	Cable Crim.	100	4"	30	1.3/16"							1000@		8.500

(1) Exclusive design for M14 x 2 and W5/8" (Code R88) or for M10 x 1,25 and M10 x 1,50 (Code R77)

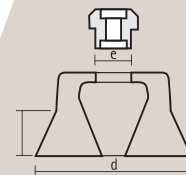

order example:
TOG 1000E M14
 1. Model: **TOG**
 2. Code: **1000E**
 3. Arbor hole: **M14**

Cups with Protection Guard

Protection

When the brush is working the guard acts as a protection shield that prevents not only wire projection but also protects the user against dust and particles generated at work.

Visibility

The guard is made of a transparent material that allows the user to see the working area.

Flexibility

These brushes are ideal for open surfaces. However, the flexibility and adaptability of the plastic material permits the access of the brush to difficult and more hidden areas. Direct contact with other materials will result in an ever wear of the shield.

It also provides for a more friendly handling of the brush, protecting end users against potential pricking caused by the wire.

High Speed Line with Protection Guard

WIRE BRUSHES / BRUSHES WITH PROTECTION GUARD



Model	Type of Wire	Diámetro mm	Trim Length (s) "	Thread	Coated Steel 0,30 mm .012"	Grey Steel 0,50 mm .020"	Stainless Steel 0,30 mm .012"	0,50 mm .020"	Cable Coated Steel	R.P.M. Max.
HSCG	Crimped	75	3"	22	7/8"	0075E	0075Z			13.000
HSTG	Twisted	65	2.3/4"	20	3/4"	M10-M14	0065K	0065Q		15.000
HCAG	Cable Crim.	75	3"	22	7/8"	W5/8"			0075@	13.000
HSDG	Crimped	100	4"			Multi R (1)	0100E	0100Z		13.000
HSKG	Twisted	100	4"				0100K	0100Q		15.000

(1) (1) Exclusive design for M14 x 2 and W5/8" (Code R88) or for M10 x 1,25 and M10 x 1,50 (Code R77)

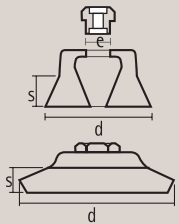

order example:
HSCG 0075E M14
 1. Model: **HSCG**
 2. Code: **0075E**
 3. Arbor hole: **M14**



Hardware Line with Protection Guard

WIRE BRUSHES / BRUSHES WITH PROTECTION GUARD



Model	Type of wire	Diámetro	Shank	Coated Steel 0,30 mm / .012"	Bulk	Display	R.P.M. Max.
BDEG	Crimped	75	3"	6,35 mm	7530	9548	4.500
BTEG	Crimped	75	3"	1/4"	7530	9628	4.500

order example:
BDEG 7530
 1. Model: **BDEG**
 2. Code: **7530**

2.8

LAMINATED BRUSHES

Laminated Wire Brushes Crimped / Knotted

WIRE BRUSHES / LAMINATED BRUSHES



Model	Type of wire	(d) Diameter mm "	(s) Trim Length mm "	(e) Arbor Hole	Laminated wire (3x0,20) + (6x0,35)	0,50	R.P.M. Max
CTP	Crimped	150 6"	20 3/4"	Multithread*	1505W		6.500
TOP	Crimped	100 4"	30 1.3/6"	M10-M14 W5/8"	1000W		8.500
TTP	Knotted	100 4"	27 1.1/8"	5/8" UNC, Multi R (1)		1001Y	8.500

(1) Exclusive design for M14 x 2 and W5/8" (Code R88) or for M10 x 1,25 and M10 x 1,50 (Code R77)

(*) Bore sizes: 13-16-20-22-26-30-50 mm (1/2"-5/8"-3/4"-7/8"-1"-1.3/16"-2") Code 99

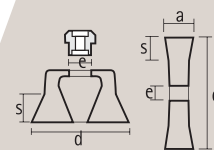

order example:
TOP 1000W M14

1. Model: **TOP**
2. Code: **1000W**
3. Arbor hole: **M14**

Easy Handling

This sort of brushes have their wires laminated. By this way they become more comfortable and safer in its handling and it avoids all kind of pricks to the user.

High Performance

Laminated wire brushes have a higher performance due to less wire fractures compared to traditional wire brushes without plastic cover.

Distinctive appearance

The plastic cover can be presented in several colours giving a customized and distinctive appearance comparing to traditional wire brushes.

High Speed Line with Laminated Wire Crimped / Knotted

WIRE BRUSHES / LAMINATED BRUSHES



Model	Type of wire	(d) Diameter mm "	(s) Trim Length mm "	(e) Arbor Hole	Laminated wire (3x0,20) + (6x0,35) 0,50	R.P.M. Max.
HSCP	Crimped	75 3"	22 7/8"	M14, M10 W5/8	0075W	15.000
HSTP	Knotted	65 2.9/16"	20 3/4"	5/8" UNC	0065Y	15.000
HSRP	Knotted	115 4.1/2"	26 1"	Multi R (1)	0115Y	15.000

(1) Exclusive design for M14 x 2 and W5/8" (Code R88) or for M10 x 1,25 and M10 x 1,50 (Code R77)

order example:
HSCP 0075W M14

1. Model: **HSCP**
2. Code: **0075W**
3. Arbor hole: **M14**

Applications

- For continuous and frequent brushing processes (ship building, metallic structures, welding, maintenance, etc.).
- Exclusive design and patented multifitting thread in two different versions; one is valid for M14 and 5/8- 11 attachments; the other is valid for M10 x 1,5 and M10 x 1,25 systems. The new design is also extended to single threads. It allows an easier attachment and increases resistance resulting in more safety for the user.



2.9

OTHER INDUSTRIAL BRUSHES

BA / BB / BC / BF / BH Plain Cut End Brush

WIRE BRUSHES / OTHER INDUSTRIAL BRUSHES

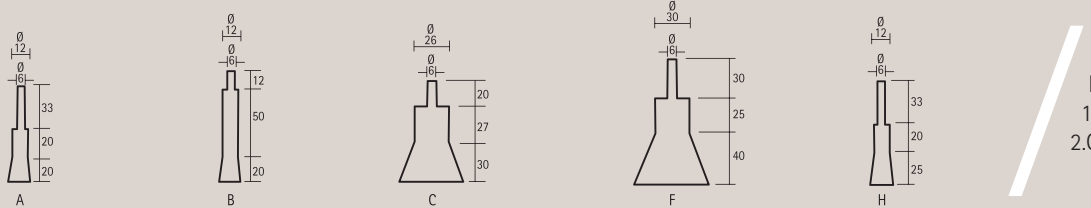
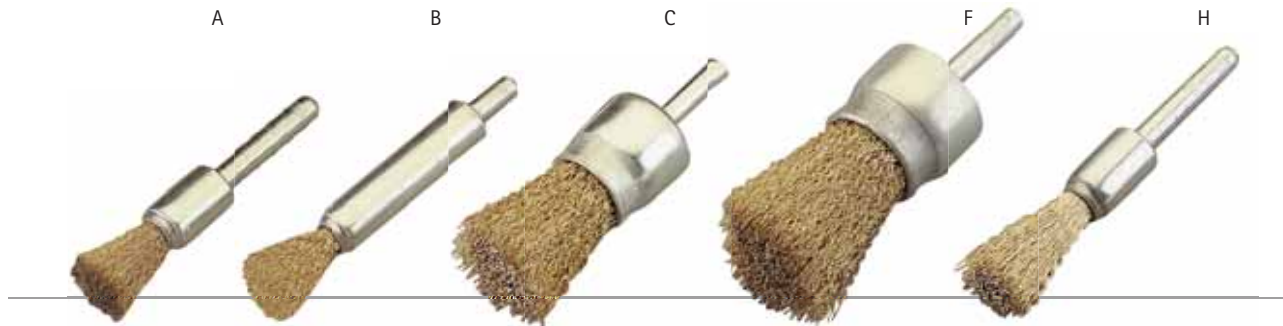

order example:
BC2600E
 1.Model: **BC**
 2.Code: **2600E**

Model	Overall Diam.		Trim length		Grey St. 0,12 mm .005"	Coated Steel					Cable coated steel	Brass 0,30 mm .012"	R.P.M. Max.
	mm	"	mm	"		0,20 mm .008"	0,30 mm .012"	0,40 mm .016"	0,50 mm .020"	Stainless 0,20 mm .008"			
BA	12	1/2"	20	3/4"	1200A	1200C	1200E	1200H	1200N	1200Z	1200@	1200V	20.000
BB	12	1/2"	20	3/4"	1201A	1201C	1201E	1201H	1201N	1201Z		1201V	20.000
BC	15	5/8"	25	1"	1500A	1500C	1500E	1500H	1500N		1500@	1500V	20.000
BC	26	1"	30	1.3/16"	2600A	2600C	2600E	2600H	2600N	2600Z	2600@	2600V	20.000
BF	30	1.3/16"	40	1.5/8"	3000A	3000C	3000E	3000H		3000Z		3000V	20.000
BH	12	1/2"	25	1"				1225G					20.000

BD / BI Angle Cut End Brush

WIRE BRUSHES / OTHER INDUSTRIAL BRUSHES

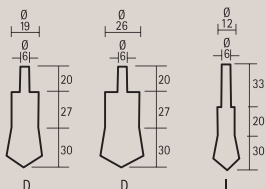

order example:
BD1901E
 1.Model: **BD**
 2.Code: **1901E**



Model	Overall Diam.		Trim length		Grey St. 0,12 mm .005"	Coated Steel					Stainless 0,30 mm .012"	Brass 0,30 mm .012"	R.P.M. Max.
	mm	"	mm	"		0,20 mm .008"	0,30 mm .012"	0,40 mm .016"	0,50 mm .020"				
BD	19	3/4"	30	1.3/16"	1901A	1901C	1901E	1901H	1901Z	1901V	20.000		
BD	26	1"	30	1.3/16"	2601A	2601C	2601E	2601H	2601Z	2601V	20.000		
BI	12	1/2"	30	1.3/16"				1230G			20.000		

BE Round Cut End Brush

WIRE BRUSHES / OTHER INDUSTRIAL BRUSHES



E



order example:
BE2602E
 1.Model: **BE**
 2.Code: **2602E**

Model	Overall Diam.		Trim length		Grey St.	Coated Steel			Stainless	Brass	R.P.M. Max.
	mm	"	mm	"	0,12 mm ".005"	0,20 mm ".008"	0,30 mm ".012"	0,50 mm ".020"	0,30 mm ".012"	0,30 mm ".012"	
BE	26	1"	30	1.3/16"	2602A	2602C	2602E	2602H	2602Z	2602V	20.000

BR Twist Knot End Brush

WIRE BRUSHES / OTHER INDUSTRIAL BRUSHES



R



R



R

Model	Overall Diam.		Trim length		Stainless		Grey St.	R.P.M. Max.
	mm	"	mm	"	0,40 mm ".016"	0,50 mm ".020"	0,50 mm ".020"	
BR	19	3/4"	25	7/8"	1900Z	1900Q	1900K	20.000
BR	25	1"	25	7/8"	2500Z	2500Q	2500K	20.000
BR	30	1.3/16"	25	7/8"	3000Z	3000Q	3000K	20.000

Possibility to laminate the outside cup and avoid sparks.



order example:
BR1900Z
 1.Model: **BR**
 2.Code: **1900Z**

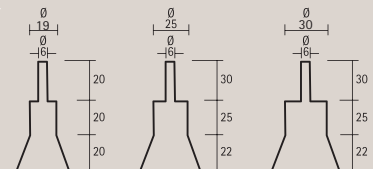

BCP Special Cut End Brush

WIRE BRUSHES / OTHER INDUSTRIAL BRUSHES

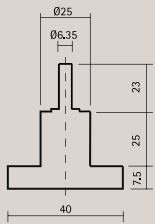

order example:
BCP00K
 1.Model: **BCP**
 2.Code: **00K**



Model	Overall Diam. mm	"	Grey St. 0,50 mm .020"	Stainless 0,50 mm .020"	R.P.M. Max.
BCP	40	1.5/8"	00K	00Q	15.000



Technical Information

- Shape and dimensions for use in difficult places to access, holes, corners, etc.
- Used on portable or fixed drills with chuck.

Applications

- Removal of edges, scale, paint, rust, rubber-metal pieces etc.
- Dies, tubes, engines, pistons, etc.

CAM with Shank

WIRE BRUSHES / OTHER INDUSTRIAL BRUSHES

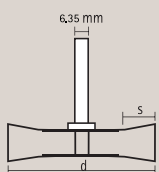

order example:
CAM 8000J
 1.Model: **CAM**
 2.Code: **8000J**



Model	Diameter (d)		Trim length (s)		Face Width (a)		Grey Steel		Stainless Steel		R.P.M. Max.
	mm	"	mm	"	mm	"	0,37 mm .015"	0,50 mm .020"	0,50 mm .020"		
CAM	80	3.1/4"	15	5/8"	10	3/8"	8000J	8000K	8000Q	20.000	
CAM	100	4"	25	1"	10	3/8"	1000J	1000K	1000Q	15.000	

CAE Twist Knot Wheel with 6 mm Shank

WIRE BRUSHES / OTHER INDUSTRIAL BRUSHES



Diameter (d)		Trim Length (s)		Face Width (a)		Grey Steel	Stainless	R.P.M. Max.
mm	"	mm	"	mm	"	0,50 mm .020"	0,50 mm .020"	
75	3"	15	5/8"	6	1/4"	7500K	7500Q	20.000

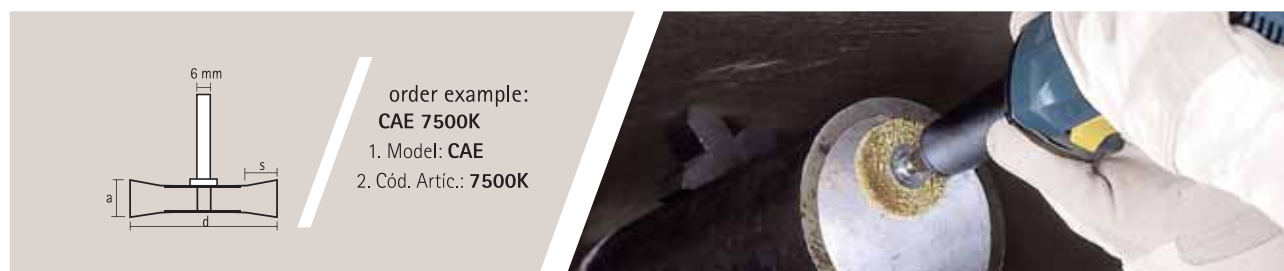

CDE Small Industrial Wheel with 6 mm Shank

WIRE BRUSHES / OTHER INDUSTRIAL BRUSHES



Diameter (d)		Trim Length (s)		Face Width (a)		Coated Steel		Stainless		Brass	R.P.M. Max.
mm	"	mm	"	mm	"	0,20 mm .008"	0,30 mm .012"	0,20 mm .008"	0,30 mm .012"	0,30 mm .012"	
30	1.3/16"	4	5/32"	10	3/8"	3000C		3000N			20.000
30	1.3/16"	4	5/32"	15	5/8"	3015C		3015N			20.000
40	1.9/16"	9	3/8"	10	3/8"	4000C		4000N			20.000
40	1.9/16"	9	3/8"	15	5/8"	4015C		4015N			20.000
50	2"	9	3/8"	10	3/8"	5000C		5000N			15.000
50	2"	9	3/8"	15	5/8"	5015C		5015N			15.000
50	2"	9	3/8"	20	3/4"	5020C		5020N			15.000
50	2"	9	3/8"	25	1"	5025C		5025N			15.000
60	2.3/8"	16	5/8"	10	3/8"		6010E		6010Z		15.000
60	2.3/8"	16	5/8"	15	5/8"		6000E		6000Z	6000V	15.000
60	2.3/8"	16	5/8"	20	3/4"		6020E		6020Z		15.000
60	2.3/8"	16	5/8"	25	1"		6025E		6025Z		15.000
75	3"	23	7/8"	10	3/8"		7510E		7510Z		15.000
75	3"	23	7/8"	15	5/8"		7500E		7500Z	7500V	15.000
75	3"	23	7/8"	20	3/4"		7520E		7520Z		15.000
75	3"	23	7/8"	25	1"		7525E		7525Z		15.000
100	4"	30	1.3/16"	15	5/8"		1000E		1000E	1000V	15.000



Technical Information CDE & CAE

- For use in difficult places to access.
- CDE: for drills with a chuck of 6 mm.
- CAE: high removal capacity and high speed.

Applications CDE & CAE

- Removal of rust, paint, scale, edges or any kind of adherence.
- CDE: inside cleaning of tubes, dies, holes, etc.
- CAE: rust, paint, scale or any kind of adherence.

2.10

WIRE, HAIR AND NYLON TUBE BRUSHES

L1 / L2 Rigid Tubebrushes L1 with Simple Spiral, L2 with Double Spiral

WIRE BRUSHES / WIRE, HAIR AND NYLON TUBE BRUSHES

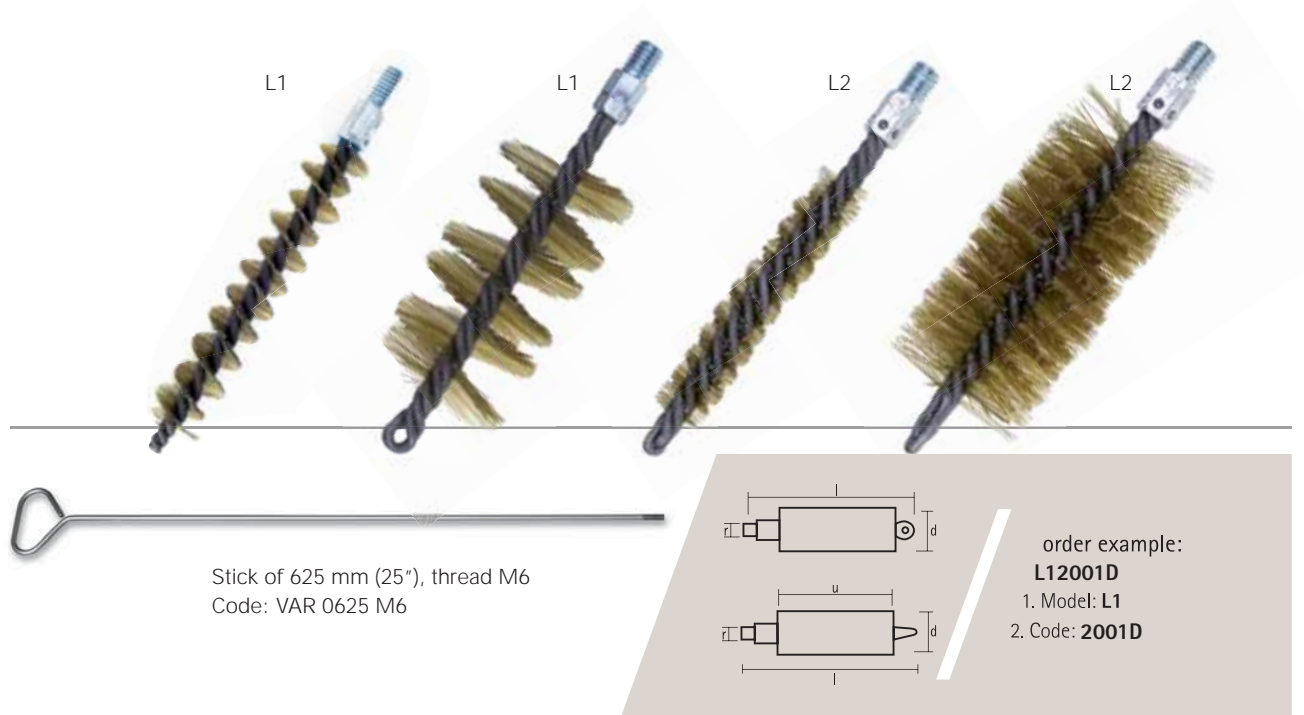

(d) Outside Diameter mm	(l) Total Length "	(u) Usable Length mm	(r) Standard Nipple	L1			L2			
				Coated Steel 0,25 mm .010"	Brass 0,40 mm .016"	Stainless 0,20 mm .008"	Steel 0,40 mm .016"	Steel 0,40 mm .016"		
10	3/8"	140	5.1/2"	110	4.3/8"	1001D		1001V	1001N	
12	1/2"	140	5.1/2"	110	4.3/8"	1201D		1201V		
13	1/2"	140	5.1/2"	110	4.3/8"	1301D		1301V		
14	9/16"	140	5.1/2"	110	4.3/8"	1401D		1401V		
15	19/32"	140	5.1/2"	110	4.3/8"	1501D		1501V	1501N	
16	5/8"	140	5.1/2"	110	4.3/8"	1601D		1601V		
18	11/16"	140	5.1/2"	110	4.3/8"	1801D		1801V		
20	3/4"	140	5.1/2"	110	4.3/8"	2001D		2001V	2001N	
25	1"	190	7.1/2"	120	4.3/4"		2501G	2501X	2501P	2502G
30	1.3/16"	190	7.1/2"	120	4.3/4"		3001G	3001X	3001P	3002G
35	1.3/8"	190	7.1/2"	120	4.3/4"		3501G			
40	1.5/8"	190	7.1/2"	120	4.3/4"		4001G		4001P	4002G
45	1.3/4"	190	7.1/2"	120	4.3/4"		4501G			
50	2"	190	7.1/2"	120	4.3/4"		5001G	5001X	5001P	5002G
55	2.5/32"	190	7.1/2"	120	4.3/4"		5501G			
60	2.3/8"	190	7.1/2"	120	4.3/4"		6001G		6001P	6002G
65	2.3/4"	190	7.1/2"	120	4.3/4"		6501G			
70	2.3/4"	190	7.1/2"	120	4.3/4"		7001G	7001X	7001P	7002G
75	3"	190	7.1/2"	120	4.3/4"		7501G			
80	3.5/32"	190	7.1/2"	120	4.3/4"		8001G			
90	3.9/16"	190	7.1/2"	120	4.3/4"		9001G			
100	4"	190	7.1/2"	120	4.3/4"		0101G			
125	5"	190	7.1/2"	120	4.3/4"		0251G			
150	6"	190	7.1/2"	120	4.3/4"		0501G			

L-1. Any diameter between 10 mm (3/8") and 150 mm (6") may be produced on request.

L-2. Any diameter between 20 mm (3/4") and 150 (6") may be produced on request.

L-2. Tubebrushes. The range L2 is available in wire diameters, different from the attached chart. You can make us an enquiry.

L1F Flexible Tubebrushes L1 with Simple Spiral

WIRE BRUSHES / WIRE, HAIR AND NYLON TUBE BRUSHES



Technical Information

- They are used manually or fastened to portable or fixed machines.
- Fastened by the screw at one end of the brush.

Applications

- Removal of rust, residues and adherences inside tubes and holes (ships, sugar factories, refineries, heaters, shock absorber factories, etc.).
- Cleaning of threaded holes.

Outside Diameter (d)		Total Length (l)		Usable Length (u)		Standard Nipple (r)	L1 Coated Steel	
mm	"	mm	"	mm	"		0,25 mm .010"	0,40 mm .016"
10	3/8"	140	5.1/2"	110	4.3/8"	W 1/4"		1001D
12	1/2"	140	5.1/2"	110	4.3/8"			1201D
13	1/2"	140	5.1/2"	110	4.3/8"			1301D
14	9/16"	140	5.1/2"	110	4.3/8"			1401D
15	19/32"	140	5.1/2"	110	4.3/8"			1501D
16	5/8"	140	5.1/2"	110	4.3/8"			1601D
18	11/16"	140	5.1/2"	110	4.3/8"			1801D
20	3/4"	140	5.1/2"	110	4.3/8"			2001D
25	1"	190	7.1/2"	120	4.3/4"			2501G
30	1.3/16"	190	7.1/2"	120	4.3/4"			3001G
35	1.3/8"	190	7.1/2"	120	4.3/4"		3501G	
40	1.5/8"	190	7.1/2"	120	4.3/4"		4001G	
45	1.3/4"	190	7.1/2"	120	4.3/4"		4501G	
50	2"	190	7.1/2"	120	4.3/4"		5001G	
55	2.5/32"	190	7.1/2"	120	4.3/4"	W 1/2"		5501G
60	2.3/8"	190	7.1/2"	120	4.3/4"			6001G
70	2.3/4"	190	7.1/2"	120	4.3/4"			7001G
75	3"	190	7.1/2"	120	4.3/4"			7501G
80	3.5/32"	190	7.1/2"	120	4.3/4"			8001G
90	3.9/16"	190	7.1/2"	120	4.3/4"			9001G
100	4"	190	7.1/2"	120	4.3/4"			0101G

L-1. Any diameter between 10 mm (3/8") and 150 mm (6") may be produced on request.

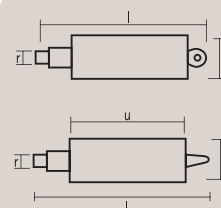

order example:
L1F2001D
 1. Model: **L1F**
 2. Code: **2001D**

LB Hair Bottle Cleaner

WIRE BRUSHES / WIRE, HAIR AND NYLON TUBE BRUSHES

order example:
LB 0070
 1. Model: **LB**
 2. Code: **0070**



Ext. Diameter mm "	Total Length mm "	Useful Length mm "	Item
50 2"	320 12.3/4"	100 4"	LB 0050
60 2.3/8"	320 12.3/4"	100 4"	LB 0060
70 2.3/4"	320 12.3/4"	100 4"	LB 0070

If you need different diameters, contact us

LR Hair Radiator Cleaner

WIRE BRUSHES / WIRE, HAIR AND NYLON TUBE BRUSHES

order example:
LR 0075
 1. Model: **LR**
 2. Code: **0075**



Ext. Diameter mm "	Total Length mm "	Useful Length mm "	Item
75 3"	700 28"	120 4.3/4"	LR 0075

If you need different diameters, contact us

LNY Nylon Spiral

WIRE BRUSHES / WIRE, HAIR AND NYLON TUBE BRUSHES

order example:
LNY 0012
 1. Model: **LNY**
 2. Code: **0012**



Ext. Diameter mm "	Total Length mm "	Useful Length mm "	Item
6 2/8"	310 12.3/8"	100 4"	LNY 0006
8 3"	310 12.3/8"	100 4"	LNY 0008
10 3/8"	310 12.3/8"	100 4"	LNY 0010
12 1/2"	310 12.3/8"	100 4"	LNY 0012
15 5/8"	310 12.3/8"	100 4"	LNY 0015
20 3/4"	310 12.3/8"	100 4"	LNY 0020
25 1"	310 12.3/8"	100 4"	LNY 0025
30 1.1/8"	310 12.3/8"	100 4"	LNY 0030

If you need different diameters, contact us

2.11

HAND BRUSHES

VIP Universal Hand Brush Plastic Handle

WIRE BRUSHES / HAND BRUSHES



Exhibitor Box

Packing of 24 pieces can be turned into an exhibitor box by an easy assembly.

(l) Total Length		(u) Usable Length		Face Width		(s) Trim Length		Coated Steel	Stainless	Brass	Pieces per Box
mm	"	mm	"	mm	"	mm	"	0,35 mm 0.014"	0,30 mm 0.12"	0,30 mm 0.12"	
255	10"	123	5"	16	5/8"	28	1.1/8"	1000F	1000Z	1000V	24

This model can even penetrate 8 mm wide slots.

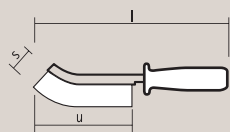

order example:
VIP 1000F
 1. Model: **VIP**
 2. Code: **1000F**



Technical Information

- Special design offering:
 - Long working life.
 - Maximum removal capacity.
- High wire density for a higher brushing pressure.
- Narrow face to allow easy access into slots (8 mm).

Applications

- Welding: cleaning and scale removal.
- Removal of rust, paint and any kind of adherence.
- Appropriate for household and DIY due to its universal and comfortable use.

MS European Type Wooden Handle

WIRE BRUSHES / HAND BRUSHES

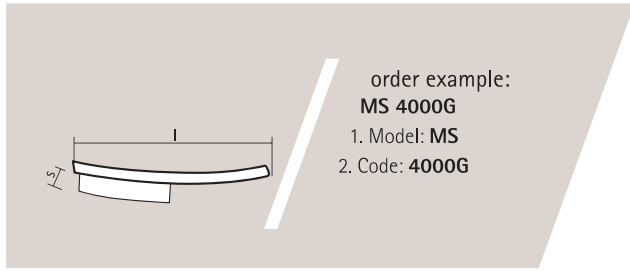

order example:
MS 4000G
 1. Model: **MS**
 2. Code: **4000G**



No of Rows	N° of Knots	(l) Total Length		(s) Trim Length		Coated St. rounded	Grey Steel Flat	Brass	Stainless	PCS. Per Box
		mm	"	mm	"	0,40 mm/.016"	0,90x0,50 mm/.040x.020"	0,40 mm .016"	0,40 mm .016"	
3	40	290	11.3/8"	30	1.3/16"	3000G	3000T	3000X	3000P	30
4	50	290	11.3/8"	30	1.3/16"	4000G	4000T	4000X	4000P	24
5	64	290	11.3/8"	30	1.3/16"	3000G	5000T	5000X	5000P	20

MF Straight Back Wooden Handle

WIRE BRUSHES / HAND BRUSHES

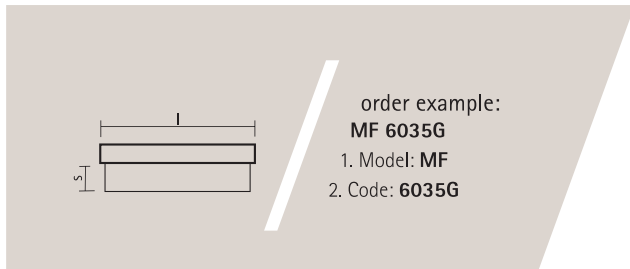

order example:
MF 6035G
 1. Model: **MF**
 2. Code: **6035G**



No. of Rows	No. of Knots	(l) Total Length		(s) Trim Length		Coated St. Rounded	Grey Steel Flat	Brass	Stainless	PCS. Per Box
		mm	"	mm	"	0,40 mm/.016"	0,90x0,50 mm/.040x.020"	0,40 mm .016"	0,40 mm .016"	
5	60	180	7"	30	1.3/16"	5030G	5030T	5030X	5030P	30
6	80	200	8"	35	1.3/8"	6035G	6035T	6035X	6035P	24
6	80	200	8"	50	2"	6050G	6050T			20

MFG Straight Back Adjustable Wooden Handle

WIRE BRUSHES / HAND BRUSHES

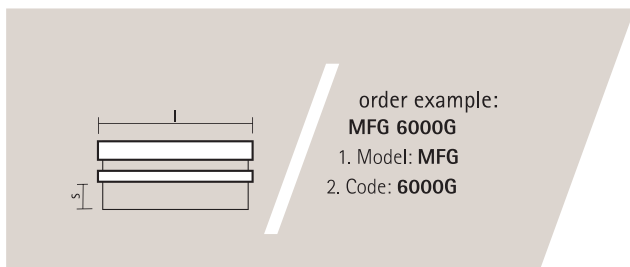

order example:
MFG 6000G
 1. Model: **MFG**
 2. Code: **6000G**



No of Rows	No of Knots	Wood Length	(s) Trim Length		Coated Steel	PCS. Per Box
		mm	mm	"	0,40 mm/.016"	
6	80	200	50	2"	6000G	20

Applications

- Removal of sand on forged pieces.
- Stone polishing.
- Obtention of rustic appearance on wood.
- Removal of rust, paint and any kind of adherence.

Wire and Sweeping Brooms Coated Steel Wire

WIRE BRUSHES / HAND BRUSHES

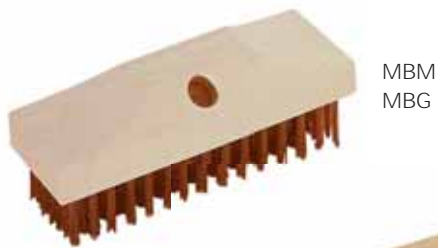

Model	No of Rows	No of Knots	(l) Wood Length mm pulgadas	Wood Width mm "	(s) Trim Length mm "	Handle Hole mm "	Coated Steel 0,40 mm/.016"	PCS. Per Box
MBM	6	80	205 8.1/16"	70 2.3/4"	35 1.3/8"	22 7/8"	6022G	12
MBG	7	109	205 8.1/16"	70 2.3/4"	35 1.3/8"	22 7/8"	7022G	12
MBC	7	171	360 14.5/32"	65 2.3/4"	50 2"	22 7/8"	7024G	12
MBCP	7	171	360 14.5/32"	65 2.3/4"	50 2"	Flat wood	7000G	12

Accesories for Brooms

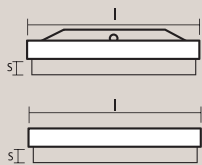

order example:
MBM 6022G
1. Model: **MBM**
2. Code: **6022G**

Palo 2200
Cylindrical stick of 22 mm. (7/8") and a total length of 1.150 mm. (45.1/4").

Palo 2800
Reinforced Broom brace, with stick of 28 mm. (1.1/8") and a total length of 1.200 mm. (47.1/4").

MGAR 2820
Cylindrical stick of 28 mm. (1.1/8") and a total length of 1,150 mm. (15.1/4").

MGAR 2800
Loose Reinforced broom brace.

Applications

- Hard sweeping of streets, civil works, ships, stables, factory shops, industrial floors, etc.

Sweeping Broom Plastic Fiber

WIRE BRUSHES / HAND BRUSHES

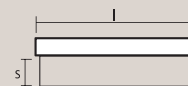

order example:
MBB 5000
1. Model: **MBB**
2. Code: **5000**

Model	Material	Density	Accessories	Wood Dimension (s) mm "	No Trim Length mm "	Code	PCS. per Box
MBB	Plastic Fiber	Medium		500 x 60 20 x 2.3/8"	95 3.3/4"	5000	24
MBB	Plastic Fiber	Medium	Stick and Broom brace	500 x 60 20 x 2.3/8"	95 3.3/4"	5028	24
MPRO	Proex	High		500 x 60 20 x 2.3/8"	85 3.3/8"	3000	18
MPRO	Proex	High	Stick and Broom brace	500 x 60 20 x 2.3/8"	85 3.3/8"	3028	18

Various Hand Brushes Steel, Brass, Mexil, Hair

WIRE BRUSHES / HAND BRUSHES



Model	No. of Rows	(l) Length mm	"	(d) Width mm	"	(s) Trim Length mm	"	(o) Hole mm	"	Material	Code	PCS. Per Box
MC		190	7.1/2"	55	2.5/32"					Steel	1001	24
MJ	4	230	9"	20	3/4"	20	3/4"			Brass	4015	36
MJ	5	230	9"	24	15/16"	20	3/4"			Brass	5015	24
MLB		135	5.5/16"	15	5/8"	15	5/8"			Steel	4515	48
MLB		135	5.5/16"	15	5/8"	15	5/8"			Brass	4530	48
MLB		135	5.5/16"	15	5/8"	15	5/8"			Nylon	4520	48
MPB		120	4.3/4"	25	1"			13	1/2"	Steel	1000	12
MX	4	175	7"	50	2"	25	1"			Mexil	4900	20
MBX	5	220	8.3/4"	60	2.3/8"	30	1.3/16"	22	7/8"	Mexil	5100	12
MP	5	280	11"	46	1.3/4"	50	2"			Hair	5000	24

order example:

MC 1001

1. Model: **MC**

2. Code: **1001**

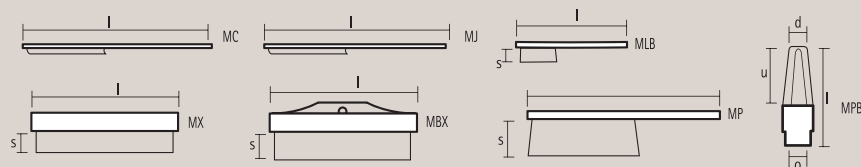

Applications

CLEANING OF :

- Files & Tools (MC).
- Jewelry, electronics, craftsmanship, leather (clothes & shoes) (MJ).
- Spark-plug (MLB).

- Battery terminals (MPB).
- Machines, work stations, furniture, home, car (MP).
- Scrubbing of ship floors, terraces, pools, bathrooms (MX, MBX).

Sectors

- Ship Maintenance, Electronics, Jewelry, Industrial Maintenance, Car (Battery), Household.

2.12

DIY BRUSHES

BDER Wheel DIY with Shank of 6mm (1/4")

WIRE BRUSHES / DIY BRUSHES



order example:
BDER 7530
 1. Model: **BDER**
 2. Code: **7530**

Model	Diámetro mm	"	Wire Type	mm	"	Packing Bulk	Display	PCS. Per Box
BDER	50	2"	Coarse	0,30	.012"	5030	9348	24
BDER	50	2"	Fine	0,20	.008"	5020	9349	24
BDER	60	2.3/8"	Coarse	0,30	.012"	6030	9448	24
BDER	60	2.3/8"	Fine	0,20	.008"	6020	9449	24
BDER	75	3"	Coarse	0,30	.012"	7530	9548	24
BDER	75	3"	Fine	0,20	.008"	7520	9549	24
BDER	100	4"	Coarse	0,30	.012"	1030	9648	24
BDER	100	4"	Fine	0,20	.008"	1020	9649	24

BTE Cup DIY with Shank of 6mm (1/4")

WIRE BRUSHES / DIY BRUSHES



order example:
BTE 5030
 1. Model: **BTE**
 2. Code: **5030**

Model	Diámetro mm	"	Wire Type	mm	"	Packing Bulk	Display	PCS. Per Box
BTE	50	2"	Coarse	0,30	.012"	5030	9168	24
BTE	50	2"	Fine	0,20	.008"	5020	9169	24
BTE	75	3"	Coarse	0,30	.012"	7530	9268	24
BTE	75	3"	Fine	0,20	.008"	7520	9269	24
BTE	85	3.3/8"	Coarse	0,30	.012"	8030	9368	20
BTE	85	3.3/8"	Fine	0,20	.008"	8020	9369	20



Applications BDER & BTE

- Removal of rust, paint and any kind of adherence in gates, balconies, cars, etc.
- Cleaning of threaded holes...

BDOR Wheel DIY Arbor hole of 13 mm (½")

WIRE BRUSHES / DIY BRUSHES

order example:
BDOR 7503
 1. Model: **BDOR**
 2. Code: **7503**



CAE Twist Knot Wheel DIY with Shank of 6 mm (¼")

WIRE BRUSHES / DIY BRUSHES



Model	Diámetro mm	"	Wire Type	mm	"	Packing Bulk	Display	PCS. Per Box
BDOR	75	3"	Coarse	0,30	.012"	7503	9158	24
BDOR	75	3"	Fine	0,20	.008"	7502	9159	24
BDOR	100	4"	Coarse	0,30	.012"	1003	9258	24
BDOR	100	4"	Fine	0,20	.008"	1002	9259	24
BDOR	125	5"	Coarse	0,30	.012"	1203	9358	12
BDOR	125	5"	Fine	0,20	.008"	1202	9359	12
BDOR	150	6"	Coarse	0,30	.012"	1503	9458	12
BDOR	150	6"	Fine	0,20	.008"	1502	9459	12
CAE	75	3"	Knotted	0,50	.020"	7500K	9388	10

BBC Cup DIY with Shank of 6mm (¼")

WIRE BRUSHES / DIY BRUSHES

order example:
BBC 2630
 1. Model: **BBC**
 2. Code: **2630**



Model	Diámetro mm	"	Wire Type	mm	"	Packing Bulk	Display	PCS. Per Box
BBC	26	1"	Coarse	0,30	.012"	2630	9078	24
BBC	26	1"	Fine	0,20	.008"	2620	9079	24



Applications BDOR, BBC & CAE

- Removal of rust, paint and any kind of adherence in gates, balconies, cars, etc.
- Preparing surfaces for painting.
- Polishing of metallic pieces.
- Working on wooden rustic pieces.
- CAE: Removal of rust, paint, forge scale and adherences in general.

2.13

EXHIBITORS AND ASSORTMENT BOXES

SURT High Speed SURT 0960

WIRE BRUSHES / EXHIBITORS AND ASSORTMENT BOXES

Code	Content Qty.	Article	Thread	Box Dimensions mm / "
SURT 0960	6	HSC 0075E	M14-W5/8"	75 x 290 x 320 mm
	3	HST 0065K	Multi R (1)	3 X 11.3/8 X 12.5/8"
	2	HSD 0100E		
	1	HSK 0100K		

(1) R88 Code: Multifitting for M14 and 5/8"-11

R77 Code: For M10 x 1,5 and M10 x 1,25



CNA Abraslon CNA 6430 & CNA 9530

WIRE BRUSHES / EXHIBITORS AND ASSORTMENT BOXES

Code	Content Qty.	Article	Colour	Box Dimensions mm / "
CNA 9430	6	CNA 7500	Red	275 x 190 x 80 mm
	6	CNA 1000		10.7/8 x 7.1/2 x 3.1/8"
	4	CNA 5000		
	6	CNA 7000		
	4	CNA 2200		
	2	CNA 1600		
CNA 9530	6	CNA 7501	Blue	275 x 190 x 80 mm
	6	CNA 1001		10.7/8 x 7.1/2 x 3.1/8"
	4	CNA 5001		
	6	CNA 7001		
	4	CNA 2201		
	2	CNA 1601		



EXP Laminated Brush Exhibitor EXP 4009

WIRE BRUSHES / EXHIBITORS AND ASSORTMENT BOXES

Code	Content Qty.	Article	Box Dimensions mm / "
EXP 4009	6	CTP 1505W 99	83 X 54 X 31 mm
	4	TOP 1000W M14	
	4	TTP 1001Y M14	
	9	HSCP 0075W M14	
	9	HSTP 0065Y M14	
	6	HSRP 0115Y M14	



SURT Do It Yourself SURT 0890 & SURT 0891

WIRE BRUSHES / EXHIBITORS AND ASSORTMENT BOXES

Code	Content Qty.	Article	Description	Box Dimensions mm / "
SURT 0890	6	BDER 7530	75 mm 3" Coarse Wheel	80 x 200 x 280 mm
	6	BDER 1030	100 mm 4" Coarse Wheel	3.1/4 x 8 x 11"
	6	BTE 5030	50 mm 2" Coarse Cup	
	6	BTE 7530	75 mm 3" Coarse Cup	
SURT 0891	6	BDER 7530	75 mm 3" Coarse Wheel	80 x 200 x 280 mm
	2	BDER 7520	75 mm 3" Fine Wheel	3.1/4 x 8 x 11"
	3	BDER 5030	50 mm 2" Coarse Wheel	
	6	BTE 7530	75 mm 3" Coarse Cup	
	2	BTE 7520	75 mm 3" Fine Cup	
	5	BBC 2630	26 mm 1" End Brush	



EXP Basic Exhibitor EXP 9640

WIRE BRUSHES / EXHIBITORS AND ASSORTMENT BOXES

Code	Content Qty.	Article	Box Dimensions mm / "
EXP 9640	3	TOG 1000E	830 x 540 x 310 mm
	3	CT 1505E 99	32.11/16 x 21.1/4 x 12.1/4"
	3	CT 1705E 99	
	3	HSCG 0075E	
	3	HSDG 0100E	
	3	HSTG 0065K	
	5	BBC 9078	
	15	BDER 9548	
	5	BDER 9648	
	5	BTE 9168	
	10	BTE 9268	
	6	CNA 9475	
	6	CNA 9470	
	30	MS 3000G	
	24	VIP 1000F	

Available threads: M14, W5/8" and Multi R



EXP Guard Exhibitor EXP 4060

WIRE BRUSHES / EXHIBITORS AND ASSORTMENT BOXES

Code	Content Qty.	Article	Box Dimensions mm / "
EXP 4060	12	BDEG 9548	830 x 540 x 310 mm
	12	BTEG 9268	32.11/16 x 21.1/4 x 12.1/4"
	9	HSCG 0075E	
	6	HSTG 0065K	
	6	HSDG 0100E	
	3	HSKG 0100K	
	2	TOG 0800E	
	6	TOG 1000E	
	2	TOG 1250E	
	2	TOG 1001K	

Available threads: M14, W5/8" and Multi R



EXP General Exhibitor EXP 4250

WIRE BRUSHES / EXHIBITORS AND ASSORTMENT BOXES

Code	Content Qty.	Article	Box Dimensions mm / "
EXP 4250	6	CT 1505E 99	2,080 x 620 x 430 mm
	6	CT 1705E 99	81.7/8 x 24.7/16 x 16.15/16"
	7	CT 2005E 99	
	4	TOG 0800E	
	8	TOG 1000E	
	3	TOG 1250E	
	3	TTG 1001K	
	5	HSCG 0075E	
	5	HSP 0115E	
	5	HSDG 0100E	
	5	HSKG 0100K	
	4	HSTG 0065K	
	14	BBC 9078	
	6	BDER 9348	
	24	BDER 9548	
	12	BDER 9648	
	12	BTE 9168	
	18	BTE 9268	
	24	MS 4000G	
	24	MF 6035G	
	48	VIP 1000F	

Available threads: M14, W5/8" and Multi R





/ 03

Flexible Abrasives

3.1

FLEXIBLE HONE

FH Flexible Hone

FLEXIBLE ABRASIVES / FLEXIBLE HONE



You can use it on all types of cylinders

The FH is a flexible abrasive tool ideal for lapping, deburring cylinders, hydraulic elements, aluminum injection parts, automotive, precision parts, etc.

Tool composed of small and independent unbreakable balls tied to the center by nylon strips.

It is self-centering and adjustable, so you can adapt it to any unevenness of the surface of the hole to work.

Reduces the values of RA, but keeping Rpk Rk and Vo and keeps Rvk and volume. Achieving a perfect polished.

You can attach it, in manual and automatic machine drills.

This tool is ideal for cylinders, connecting rods, crankshafts tooling...



Diameter of the cylinder to clean		Total length		Useful length		SC grit	SC grit
mm	"	mm	"	mm	"	120	180
4	.157"	150	6"	21	5.9"		04SC18
8	.315"	203	8"	53	2.1/4"	08SC12	08SC18
9	.354"	203	8"	53	2.1/5"	09SC12	09SC18
10	.394"	203	8"	53	2.1/6"	10SC12	10SC18
12,7	1/2"	203	8"	65	2.1/7"	13SC12	13SC18
14	.552"	203	8"	65	2.1/8"	14SC12	14SC18
16	5/8"	203	8"	65	2.1/9"	16SC12	16SC18
18	.709"	203	8"	65	2.1/10"	18SC12	18SC18
20	.787"	203	8"	65	2.1/11"	20SC12	20SC18
22	7/8"	203	8"	65	2.1/12"	22SC12	22SC18
25,4	1"	203	8"	80	2.1/13"	26SC12	26SC18
29	1.1/8"	203	8"	80	2.1/15"	29SC12	29SC18
31,8	1.1/4"	203	8"	80	2.1/16"	32SC12	32SC18
35	1.3/8"	203	8"	80	2.1/17"	35SC12	35SC18
38	1.1/2"	203	8"	80	2.1/18"	38SC12	38SC18
41	1.5/8"	203	8"	80	2.1/19"	41SC12	41SC18
45	1.3/4"	203	8"	80	2.1/20"	45SC12	45SC18
48	1.7/8"	203	8"	80	2.1/21"	48SC12	48SC18
51	2"	203	8"	80	2.1/22"	51SC12	51SC18

FH Flexible Hone

FLEXIBLE ABRASIVES / FLEXIBLE HONE



order example:
FH20SC12
1.Model: **FH**
2.Article code: **20SC12**
3.Grit: **120**
2.Workpiece diameter: **20mm**

Specifications:

- Tool composed of silicon carbide balls impregnated with different grits.
- Can be used in dry surfaces or with oils having viscosity SAE 10 to 30 (it is recommended to lubricate).
- Do not use solvents during use or for cleaning the cylinders.
- For the choice of suitable diameter, this will be the inside diameter of the cylinder polish or the next higher.
- The recommended speed is between 500 and 1200 rpm. Not to be used in high-speed engines.
- Progress will be between 3 to 4.5 m / sec.
- The oscillations for correct work will be 20 to 45 seconds per cylinder. (5-15 passes).
- It is important that the tool gets into the hole and to be always in rotation
- After work, and in order to remove any residue, use soapy water and a brush Nylon spiral (LNY) of the same diameter.
- We have a wide range of dimensions, and abrasive grits outside the permanent stock table.

Applications:

- Air Compressors.
- Air Hydraulic Cylinders.
- Pneumatic Cylinders.
- Boiler componets
- Pneumatic Tools.
- Brake Cylinder
- Brake Rotors
- Cylinders and Engine Blocks
- Guns and Weapons
- Musical Instruments



3.2

ABRASIVE NYLON

DNA Wheel Abrasive Nylon 6 to 12

FLEXIBLE ABRASIVES / ABRASIVE NYLON



Outside Diameter mm	"	Face Width		Trim Length		Arbor Hole		GRIT			R.P.M. Max.		
		mm	"	mm	"			120 Coarse	180 Medium	320 Fine			
100	4"	8	5/16"	18	11/16"	13,16,20,22,26,30mm		1011	1012	1013	12000		
100	4"	16	5/8"	18	11/16"	1/2"-5/8"-3/4"-7/8"-1.3/16"		1021	1022	1023	12000		
150	6"	13	1/2"	27	1.1/16"	Multithread R (1)		1511	1512	1513	6500		
150	6"	28	1.1/8"	27	1.1/16"			1521	1522	1523	6500		
175	7"	16	5/8"	40	1.5/8"	13	1/2"	30	1.3/16"	1711	1712	1713	6500
175	2"	29	1.1/8"	40	1.5/8"	16	5/8"	32	1.1/4"	1721	1722	1723	6500
200	8"	16	5/8"	40	1.5/8"	20	3/4"	35	1.3/8"	2011	2012	2013	6000
200	8"	29	1.1/8"	40	1.5/8"	22	7/8"	36	1.3/8"	2021	2022	2023	6000
250	10"	16	5/8"	45	1.3/4"	25		40	1.5/8"	2511	2512	2513	5000
250	10"	29	1.1/8"	45	1.3/4"	26	1"	50		2521	2522	2523	5000
300	12"	16	5/8"	50	2"			50,8	2"	3011	3012	3013	4500
300	12"	29	1.1/8"	50	2"					3021	3022	3023	4500

(1) Arbor Hole: 13-16-20-22-26-30-50mm [1/2"-5/8"-3/4"-7/8"-1"-1.3/16"-2"] Code 99.

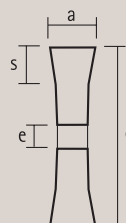

order example:
DNA 1511
 1.Model: **DNA**
 2.Article code: **1511**
 3.Grit: **120**

TNA Cup Abrasive Nylon

FLEXIBLE ABRASIVES / ABRASIVE NYLON



Outside Diameter		Trim Length		Arbor Hole	Grit			R.P.M. Max.
mm	"	mm	"		120 Coarse	180 Medium	320 Fine	
110	4.3"	35	1.3/8"	22-M14-W5/8-7/8" (1)	1101	1102	1103	8500
150	6"	30	1.3/16"	22-M14-W5/8-7/8" (1)	1501	1502	1503	6000

(1) Exclusively designed threaded M14 x 2 and W5 / 8 "-11 (Code R-88) or M10 x 1.25 and M10 x 1.50 (Code R-77).

Technical Information:

- Filaments impregnated with Silicon Carbide abrasive grains allow the brush to maintain a high cut rate while producing a consistent finish throughout the life of the brush.
- Filaments flex to all angles, and permits them to deburr and finish highly contoured parts.
- Nylon brushes are ideal when it is important that surface measures are not affected by the brushing process. Suitable for wet and dry applications.
- Although coolants and lubrication may allow the use of higher speeds than initially recommended, these R.P.M. must never be exceeded.
- Exclusive design and patented multifitting thread in two different versions; one is valid for M14 and 5/8-11 attachments; the other is valid for M10 x 1,5 and M10 x 1,25 systems. The new design is also extended to single threads. It allows an easier attachment and increases resistance resulting in more safety for the user.

Applications:

- Deburring of turbine blades and removing carbon encrustation from engines.
- Cleaning of dies, steel and cast iron pieces.
- Deburring of cylindrical parts, steering gear cases and control pistons in the automotive industry.
- Deburring of edges on aluminium extrusions, fabricated metals, powdered metals...

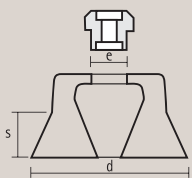

order example:
TNA 1102 M14
 1. Model: **TNA**
 2. Article Code: **1102**
 3. Arbor Hole : **M14**



CON Disc Abrasive Nylon

FLEXIBLE ABRASIVES / ABRASIVE NYLON



Outside Diameter		Trim Length		Arbor Hole	Color Black Grit 80	Color Red Grit 120	Color Yellow Grit 180	Color Blue Grit 320	R.P.M. Max.
mm	"	mm	"						
100	4"	25	1"	M14-W5/8 y DX	1010	1011	1012	1013	3000
120	5"	25	1"	M14-W5/8 y DX	1210	1211	1212	1213	3000
140	6"	25	1"	M14-W5/8 y DX	1410	1411	1412	1413	3000
250	10"	25	1"	50,8mm 2"	2510	2511	2512	2513	3000



order example:
CON 1211
 1.Model: **CON**
 2.Article code: **1211**
 3.Grit: **120**

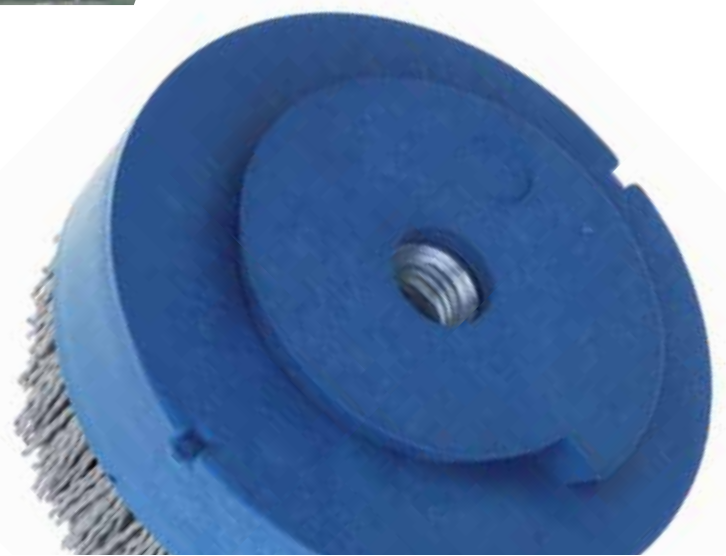

LNA Tubebrush Abrasive Nylon

FLEXIBLE ABRASIVES / ABRASIVE NYLON

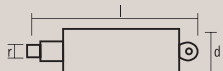

order example:
LNA 2011
 1.Model: **LNA**
 2.Article code: **2011**



Outside Diameter mm	"	Arbor Hole	Grit		
			120 Coarse	180 Medium	320 Fine
20	3/4"	W1/4"-NPT 1/8"	2011	2012	2013
25	1"		2511	2512	2513
40	1.5/8"	W1/2"-NPT 1/4"	4011	4012	4013
50	2"		5011	5012	5013

BNA End Brush Abrasive Nylon 6 to 12

FLEXIBLE ABRASIVES / ABRASIVE NYLON



Outside diameter mm	"	Trim length		Arbor hole		Grit 120 Coarse	Grit 180 Medium	Grit 320 Fine	R.P.M. Max.
		mm	"	mm	"				
12	1/2"	20	3/4"	6	1/4"	1201	1202	1203	20000
19	3/4"	30	1.3/16"	6	1/4"	1901	1902	1903	20000
25	1"	30	1.3/16"	6	1/4"	2501	2502	2503	20000

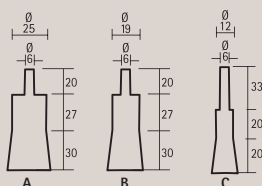

order example:
BNA 1902
 1.Model: **BNA**
 2.Article code: **1902**

CNA DIY Line Abrasive Nylon 6

FLEXIBLE ABRASIVES / ABRASIVE NYLON



Type	Diameter mm	"	Filament Colour	Grit	Packing Bulk	Display	R.P.M. Max.	PCS. Per Box
Wheel	75	3"	Red	80	7500	9475	4.500	12
Wheel	75	3"	Blue	150	7501	9575	4.500	12
Wheel	100	4"	Red	80	1000	9410	4.500	12
Wheel	100	4"	Blue	150	1001	9510	4.500	12
Cup	50	2"	Red	80	5000	9450	4.500	12
Cup	50	2"	Blue	150	5001	9550	4.500	12
Cup	75	3"	Red	80	7000	9470	4.500	12
Cup	75	3"	Blue	150	7001	9570	4.500	12
End Brush	25	1"	Red	80	2200	9422	4.500	12
End Brush	25	1"	Blue	150	2201	9522	4.500	12
Flap	100	4"	Red	80	1600	9416	4.500	12
Flap	100	4"	Blue	150	1601	9516	4.500	12

order example:
CNA 1000
 1. Model: **CNA**
 2. Article Code: **1000**



Technical Information

- Brushes made of nylon filaments impregnated with Aluminium Oxide abrasive particles.
- High flexibility without danger of breaking, providing long working life and increased safety.
- Suitable for dry applications only.
- To be used in power drills.
- Red colour nylon brushes (grit 80) produce a coarse finishing; the blue colour ones (grit 150) provide a fine polishing.

Applications

- Nylon brushes do not scratch and therefore they are appropriate for cleaning and polishing of:
- Any kind of wood (fine or rustic).
- Metallic surfaces such as automobile bodies.
- Tile, stone and concrete.
- Plastic materials.
- Stainless Steel and Aluminium.

Operating Recommended Speed

- Optimum performance is obtained at the recommended working speed 2.500 R.P.M.
- Speeds above the recommended ones may smear the workpiece due to heat build-up.

3.3

COATED ABRASIVES

DL Flap Discs with Threaded Nut M14 or 22 mm Arbor Hole (7/8 ")

FLEXIBLE ABRASIVES / COATED ABRASIVES



Abrasive Clothing	Diameter		Code	Grit			R.P.M. Max.	PCS. Per Box
	mm	"		Grit 40	Grit 60	Grit 80		
Zirconium	115	4.1/2"	DLZ 11540	DLZ 11560	DLZ 11580	13.300	10	
Zirconium	127	5"	DLZ 12740	DLZ 12760	DLZ 12780	12.000	10	
Zirconium	178	7"	DLZ 17840	DLZ 17860	DLZ 17880	8.600	10	
Alum. Oxide	115	4.1/2"	DLO 11540	DLO 11560	DLO 11580	13.300	10	
Alum. Oxide	127	5"	DLO 12740	DLO 12760	DLO 12780	12.000	10	
Alum. Oxide	178	7"	DLO 17840	DLO 17860	DLO 17880	8.600	10	

Here are also available with arbor hole of 22 (7/8") thread or Multithread (M14, W5/8", R88 and R77).



order example:
DLZ 11540 M14
 1. Model: **DLZ**
 2. Article Code: **11540**
 3. Arbor Hole: **M14**

Technical Information

- Grinding and polishing in one operation.
- The fiber glass backing allows the disc to fit into corners, without deteriorating the piece of work.
- The threaded nut results in an easier attachment to the machine, and increased safety and convenience at work.

Applications

- Grinding and sanding on metal: zirconium for hard metals (i.e. stainless steel), aluminium oxide or zirconium for other metals (carbon steel, aluminium...).
- Cleaning and removal of welding scale, corners and edges.
- Users: shipbuilding, boiler manufacturers, sheet metal shops, automotive, foundries, welding, aluminium fabricators.

AL Flap Wheels with 6 mm Shank

FLEXIBLE ABRASIVES / COATED ABRASIVES



Diameter		Width		Code			R.P.M. Max.	PCS. Per Box
mm	"	mm	"	Grit 60	Grit 80	Grit 120		
30	1.1/8"	10	3/8"	AL 301060	AL 301080	AL 301012	25.000	10
40	1.5/8"	15	5/8"	AL 401560	AL 401580	AL 401512	19.000	10
60	2.3/8"	20	3/4"	AL 602060	AL 602080	AL 602012	12.600	10
60	2.3/8"	30	1.3/16"	AL 603060	AL 603080	AL 603012	12.600	10
80	3.1/8"	30	1.3/16"	AL 803060	AL 803080	AL 803012	9.500	10

order example:
AL 603060
 1. Model: **AL**
 2. Article Code: **603060**



Technical Information

- Aluminium Oxide flaps, with highest quality resistant industrial clothing. Used in finishing operations that demand limited removal capacity.
- They adapt to all contours and shapes.
- Uniform and constant finish throughout the life of the wheel.

Applications

- Polishing and finishing on irregular surfaces and contours.
- Cleaning and removal of rust, paint, weld and scratches.
- Applications on steel, stainless and nonferrous materials (aluminium, wood, plastic).
- Users: foundries, forging, stamping, moulding, welding, wood...





/ 04

Technical Brushing

4.1

STRIP BRUSHES

Strip Brushes

TECHNICAL BRUSHING / STRIP BRUSHES



STRIP brushes allow the user a fast adaptation, since the profiles can be cut, drilled, machined etc ...

Applications:

- Door Locks
- Cleaning of conveyor belts.
- Applications in machines.
- Soundproofing
- Avoid the passage of dust.

We have in Stock brushes type H, F and Y.

Polypropylene and Nylon material with projections of fibers according to tables.

For special measures contact us directly.

- order example:
STRIP-F8-100-300
1. Model: **STRIP**
 2. Clamping bracket: **F**
 3. Article Code: **8**
 4. Trim length: **100mm**
 5. Cut length: **300mm**



Model		Reference	A (Trim length)		B (Total length)		Maximum length of 3m / 118,11"		
			mm	"	mm	"			
STRIP No.3 (Profile width: 3mm)	H3-14				30	1,18"			
	F3-14	14	0,55"	21	0,83"				
	Y3-14				30	1,18"			
	H3-24				40	1,57"			
	F3-24	24	0,94"	31	1,22"				
	Y3-24				40	1,57"			
	H3-34				50	1,97"			
	F3-34	34	1,34"	41	1,61"				
	Y3-34				50	1,97"			
	H3-44				60	2,36"			
	F3-44	44	1,73"	51	2"				
	Y3-44				60	2,36"			
H5-15				40	1,57"				
F5-15	15	0,59"	24	0,94"					
Y5-15				40	1,57"				
H5-25				50	1,97"				
F5-25	25	0,98"	34	1,34"					
Y5-25				50	1,97"				
H5-35				60	2,36"				
F5-35	35	1,38"	44	1,73"					
Y5-35				60	2,36"				
H5-45				70	2,76"				
F5-45	45	1,77"	54	2,13"					
Y5-45				70	2,76"				
H5-50				75	2,95"				
F5-50	50	1,97"	59	2,32"					
Y5-50				75	2,95"				
H5-55				80	3,15"				
F5-55	55	2,17"	64	2,52"					
Y5-55				80	3,15"				
H5-60				85	3,35"				
F5-60	60	2,36"	69	2,72"					
Y5-60				85	3,35"				
H5-80				105	4,13"				
F5-80	80	3,15"	89	3,50"					
Y5-80				105	4,13"				
H5-90				115	4,53"				
F5-90	90	3,54"	99	3,90"					
Y5-90				115	4,53"				
H8-40				90	3,54"				
F8-40	40	1,57"	53	2,09"					
Y8-40				86	3,39"				
H8-50				100	3,94"				
F8-50	50	1,97"	63	2,48"					
Y8-50				96	3,78"				
H8-60				110	4,33"				
F8-60	60	2,36"	73	2,87"					
Y8-60				106	4,17"				
H8-70				120	4,72"				
F8-70	70	2,76"	83	3,27"					
Y8-70				116	4,57"				
H8-80				130	5,12"				
F8-80	80	3,15"	93	3,66"					
Y8-80				126	4,96"				
H8-100				150	5,91"				
F8-100	100	3,94"	113	4,45"					
Y8-100				146	5,75"				
H8-120				170	6,69"				
F8-120	120	4,72"	133	5,24"					
Y8-120				166	6,54"				
H8-150				200	7,87"				
F8-150	150	5,91"	163	6,42"					
Y8-150				196	7,72"				
H8-180				230	9,06"				
F8-180	180	7,09"	193	7,60"					
Y8-180				226	8,90"				
H8-200				250	9,84"				
F8-200	200	7,87"	213	8,39"					
Y8-200				246	9,69"				
H8-220				270	10,63"				
F8-220	220	8,66"	233	9,17"					
Y8-220				266	10,47"				

Note: The STRIP brushes can be supplied without support



Technical Brushes

TECHNICAL BRUSHING / TECHNICAL BRUSHES

JAZ technical brushes like the other products are designed for optimum performance.

Our technical department can advise the customer in everything he needs. We can work on drawings or by supplying us any sample of the requested brush.

Do not hesitate to contact us.

Applications

- Machine Tool.
- Foundry.
- Conveyors.
- Automotive.
- Construction.
- Food industry.
- Steel industry.
- Cleaning Tasks.
- Soundproofing.
- Derivation of voltages.

Materials

- Steel.
- Brass coated steel
- Stainless Steel.
- Brass.
- Polypropylene.
- Polyamide.
- Fiber.

WHEEL BRUSHES

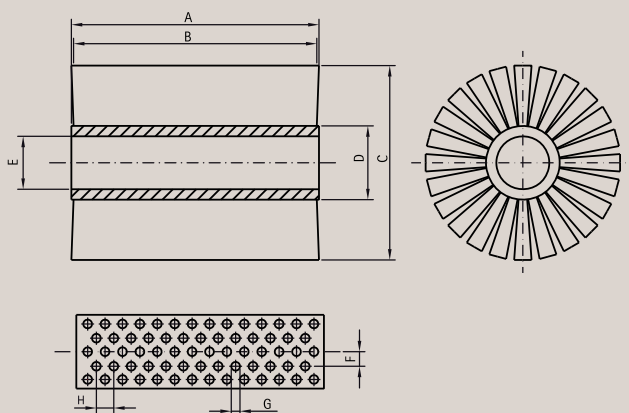

- A: Core Width
 B: Useful width
 C: Outside diameter
 D: Core diameter
 E: Tube Inside Diameter
 F: Horizontal distance to Holes
 G: Hole diameter
 H: Vertical distance to Holes

DISC BRUSHES

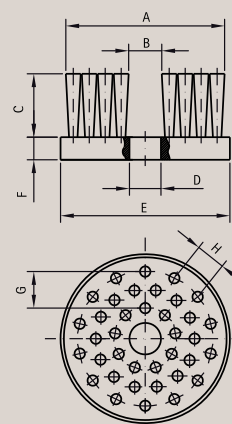

- A: Useful outside diameter
 B: Useful inside diameter
 C: Trim length
 D: Central Core Hole diameter
 E: Outside Core diameter
 F: Core Width
 G: Distance between Rows
 H: Distance between holes

LATH BRUSHES

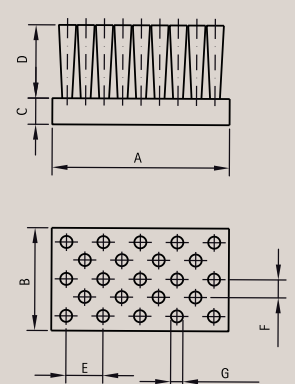

- A: Core length
 B: Core width
 C: Core Height
 D: Trim length
 E: Horizontal Distance to Holes
 F: Vertical Distance to Holes
 G: Hole diameter

4.3

BRUSHING EQUIPMENTS

Brushing Trolley CARRO 203020

TECHNICAL BRUSHES / BRUSHING EQUIPMENTS

This brushing equipment permits to cover a big working area (200 mm) and contributes to a high performance task. At the same time, this equipment offers security and comfort because the user remains always away from the brushing area.



Technical Information

- **Motor:**
 - Motor: 380 V – Three phase
 - Starting Intensity: 7,0 IA/IN
 - Frequency: 50 Hz
 - Power: 3000 W / 4C
 - Speed: 3000 rpm
 - Weight: 75,4 Kg.
- **Dimensions:**
 - Large: 700 mm
 - Width: 450 mm
 - Height: 1100 mm
- **Wire Brushes:**
 - Diameter (Ø): 200 mm
 - Width: 250 mm

Brushing Arm BRAZ 101528CR

TECHNICAL BRUSHES / BRUSHING EQUIPMENTS

Portable equipment that makes easier to brush on areas difficult to access providing safety and comfort for the end user. It avoids awkward positions when brushing floors or low areas by using an articulated arm.



Technical Information

- **Motor:**
 - Motor: 230 V – Single phase
 - Connection
 - Intensity: 8,6 A
 - Frequency: 50 Hz
 - Voltage: 220 V
 - Power: 1500 W
 - Speed: 2860 rpm
 - Weight: 23 Kg.
- **Dimensions:**
 - Large: 540 mm
 - Width: 500 mm
 - Height: 1350 mm
- **Transmission Flexible**
 - Length: 2,5 m
 - Weight: 3 Kg
- **Total Equipment**
 - Total Weight: 35 Kg.
- **Wire Brushes**
 - Max. Dimension (external dimension): 150 mm





/ 05

Street Cleaning Brushes



5.1

STREET CLEANING BRUSHES

JAZ manufactures high quality street cleaning brushes too. This sort of brushes has the objective of satisfying the needs of cleaning enterprises, communities and municipalities. Our large experience in industrial brushing allows to us starting this new phase full of confidence, so we can offer to our customers a competitive product and service.

- The new range of JAZ ZUBIAURRE SA brushes covers the needs of the main sweepers of The domestic market.
- We offer a large variety of fiber brushes (PLP, Polyester PET, Polyester PBT and Nylon 6.6), with different sections, depending on the needs of the customer; As well as steel and the mixture of both materials.
- Apart from offering a large range of standard products, our flexible manufacturing systems allows the manufacturing of customized brushes.
- We deliver our brushes directly, guaranteeing the given delivery time to the customer.

Lateral Brushes

STREET CLEANING BRUSHES



order example:
92403600
 1. Article code:
92403600



Sweeper	Base	PLP	PLP/AC	PLP/AC riz	PLE	PLE/AC	PLE/AC riz	Nylon	Nylon/AC	Steel
City Cat 2020	500x171	92101600	92403600	92421600	92115600	92417600	92421600	92106600	92407600	92118540
City Cat 5000	580x60	97101600	97403600		97115600	97E21600				
Jhonston Britain/Panoramic,	500x330									
Schmidt Swingo/Classic.	500x330	94101600	94403600	94416600	94115660	94417600	94E21600	94106660	94407600	
Dulevo 200	600x60	96101600	96403600		97115600		97E21600			
Dulevo 5000	700x60		914403600							
Eco 100/Dulevo Commando	440x50									
Piquersa 1500/2500	440x50	91101540	91403540		91115540	91417540		91106540	91407540	
Karcher Icc1	350x50	910101540	910203540		910115540	910217540				
Karcher Icc2	350x200	918188540	918403540			918417540			918420560	
Ravo/Piq 2000H/MFH	485x260	93101600	93403600	93416600	93115600	93417600	93421600	93106600		93118540
Schmidt Cleango	580x240	916101600	916403600							

If you need other dimension or material brushes, you can ask to us

Rings PR and Dividers

STREET CLEANING BRUSHES

order example:
9ARO110320PLP
 1. Article code:
9ARO110320PLP

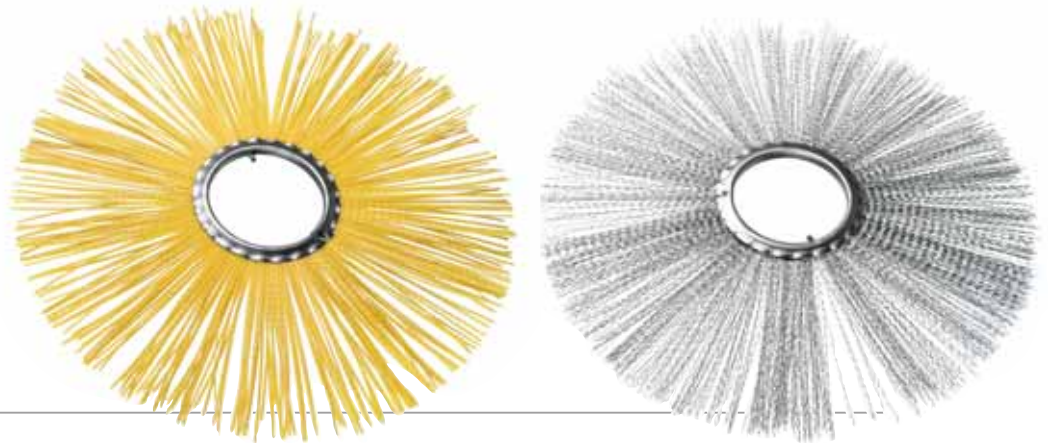

Sweeper	Ring	Polypropylene	Curly steel	Plastic Divider (25 mm)	Plastic Divider (30 mm)	Metallic Divider (22 mm)
Scarab 5000 Scarab minor	110 x 320	9ARO110320PLP	9ARO110320AC		9SEP110PLA30	
Public Works	125 x 550	9ARO125550PLP	9ARO125550AC		9SEP125PLA30	9SEP125MET22
Piquersa 1500/2500 Piquersa 2000H	127 x 480	9ARO127480PLP	9ARO127480AC	9SEP127PLA25	9SEP127PLA30	9SEP127MET22
Ausa Mustang	127 x 550	9ARO127550PLP	9ARO127550AC	9SEP127PLA25	9SEP127PLA30	9SEP127MET22
Terraco	210 x 560	9ARO210560PLP	9ARO210560AC			9SEP210MET22
Elgin Pelican	235 x 950	9ARO235950PLP	9ARO235950AC			9SEP235MET22

If you need other dimension brushes, you can ask to us.

Central Brushes

STREET CLEANING BRUSHES

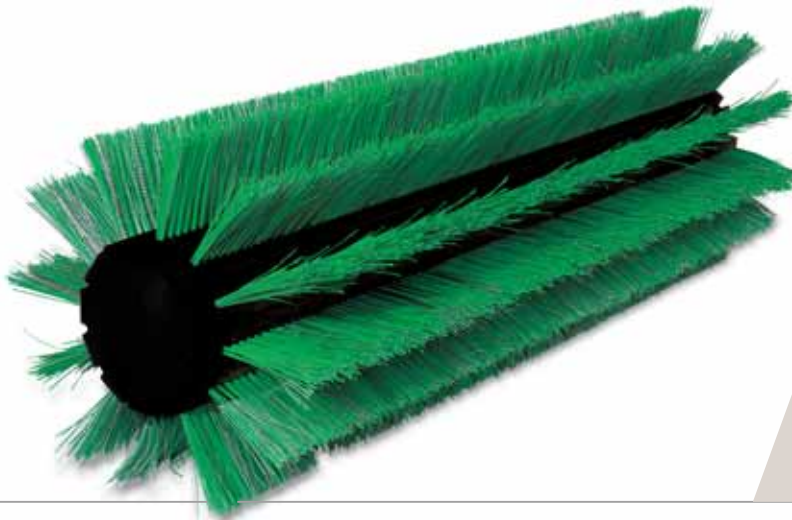

order example:
9PIQ1535POL
 1. Article code:
9PIQ1535POL

Sweeper	Polypropylene	Polypropilene/Curly Steel	Polyester	Polyester/Curly Steel	Nylon/CurlySteel
Dulevo 200/5000	9CENDU200				
Dulevo 200/5000		90120101			
Piquersa 1500/2000H*	9CENPIQ1385	9PIQ1385PLPAC		9PIQ1385POLAC	9PIQ1385NYLAC
Piquersa 2500*	9CENPIQ1535	9PIQ1535PLPAC	9PIQ1535POL	9PIQ1535POLAC	9PIQ1535NYLAC
Tennant 385	9CENTE385				
Ausa RMB 120/200 (tupido)	90120202				
Ausa RMB 120/200	9CENAU870				

If you need rolls for other machines or other dimensions, you can ask to us.

* We have strip Fast-System in polypropylene for PIQUERSA machines.

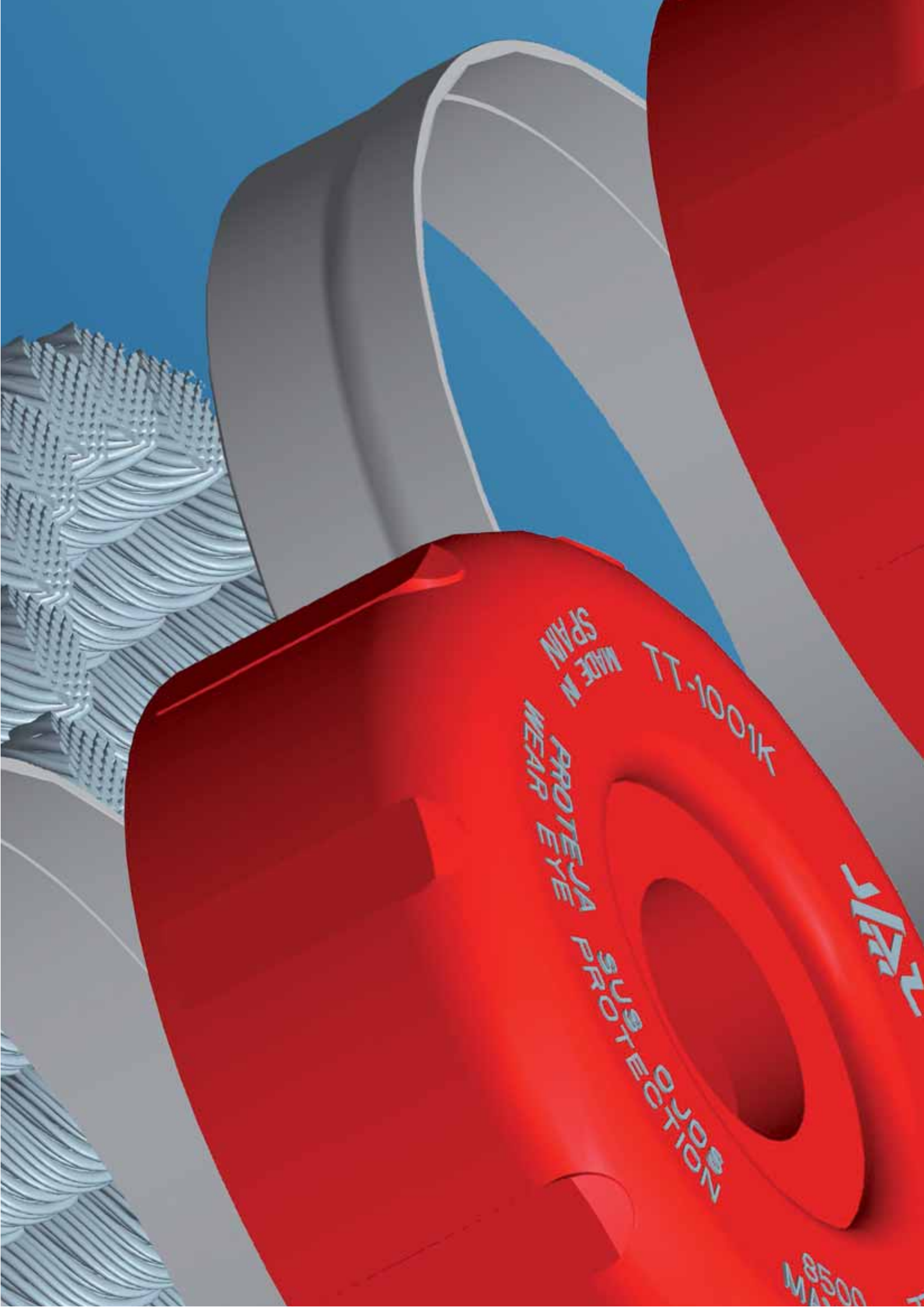

K100-11

MADE IN SPAIN

PROTEJA EYE WEAR

PROJECTE
K100-11

8500

1/2



/ 06

Plans

Drawing for brush type CT

DIMENSIONS

MATERIAL (Mark with an "X")

Estimated Annual Usage

GREY STEEL

BRASS COATED STEEL

STAINLESS STEEL

BRASS

GERMAN SILVER

LAMINATED WIRE

Wire diameter

0,08mm / .003" 0,35mm / .013"

0,12mm / .005" 0,40mm / .016"

0,15mm / .006" 0,50mm / .020"

0,20mm / .008" 0,80mm / .032"

0,30mm / .012"

CABLE CRIMPED WIRE

Cable crimped wire diameter

6w x 0,35mm+ 3h x0,20mm / 6w x .013" + 3w x .008"

12w x 0,23mm / 12h x .009"

STAINLESS STEEL CABLE WIRE

Stainless steel cable wire diameter

7w x 0,35mm / 7w x.013"

Outer diameter

Trim length

Internal Ø

Usable width

A:

B:

C:

If demanding inner bore with keyway please check the dimension values A, B and C.

Company name:

Phone:

E-mail:



JAZ ZUBIAURRE, S.A. Phone: + 34 943 120 600 / Fax: + 34 943 121 704 / jaz@jaz.es / www.jaz.es

Drawing for brush type CUCB

MATERIAL (Mark with an "X")

Estimated Annual Usage

- BRASS COATED STEEL
 STAINLESS STEEL

Wire diameter

- 0,15mm / .006" 0,35mm / .013"
 0,20mm / .008" 0,40mm / .016"
 0,25mm / .009" 0,50mm / .020"
 0,30mm / .012"

- CABLE CRIMPED WIRE

Cable crimped wire diameter

- 6w x 0,35mm+3h x 0,20mm / 6w x .013" + 3w x .008"
 12w x 0,23mm / 12h x .009"

- STAINLESS STEEL CABLE WIRE

Stainless steel cable wire diameter

- 7w x 0,35mm / 7w x .013"

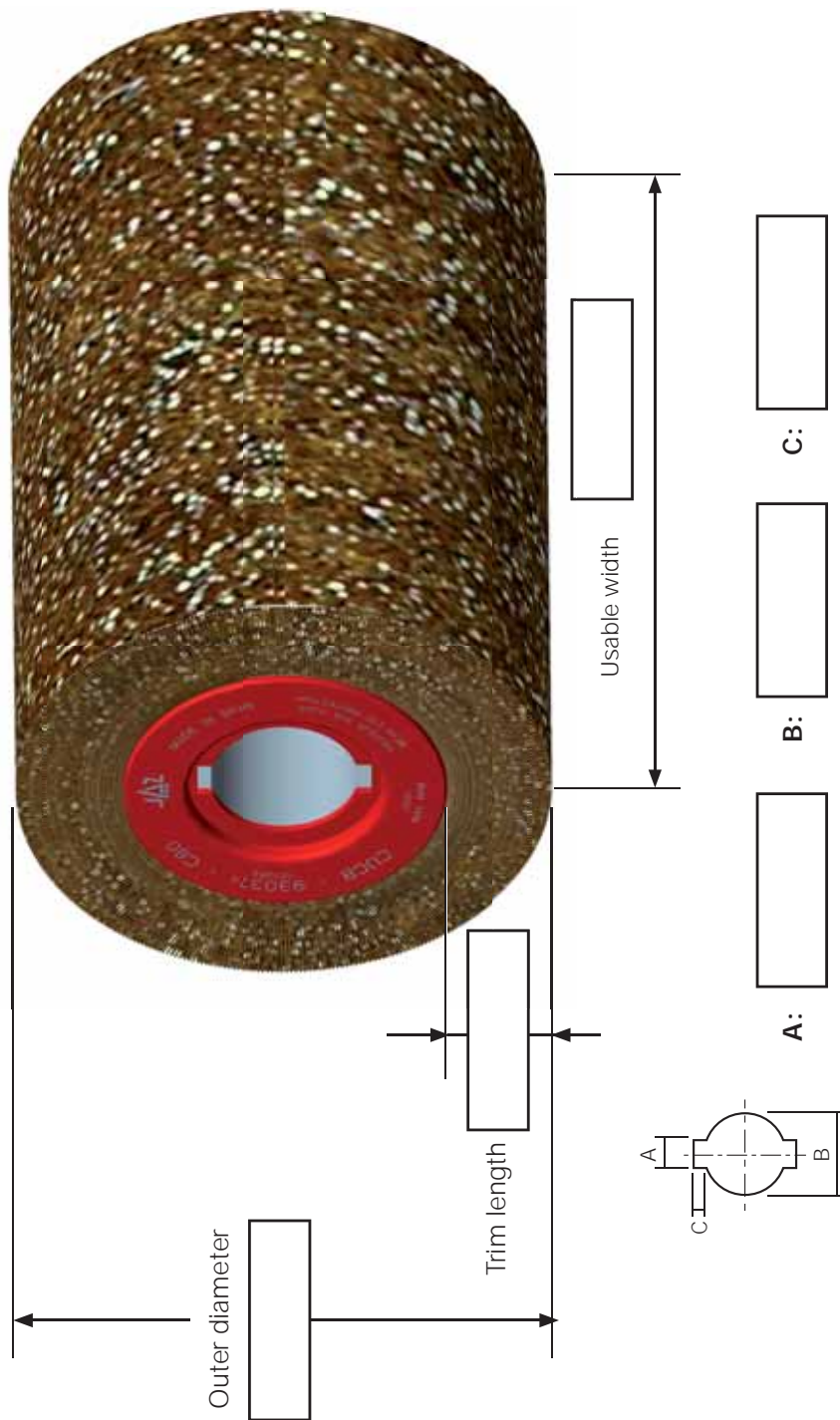

Company name:

Phone:

E-mail:

Drawing for brush type CAM

DIMENSIONS

MATERIAL (Mark with an "X")

- GREY STEEL
- BRASS COATED STEEL
- STAINLESS STEEL
- GALVANISED STEEL
- LAMINATED WIRE
- BRASS

Wire diameter

- 0,37mm / .014"
- 0,40mm / .016"
- 0,50mm / .020"
- 0,80mm / .032"

Knot type



Estimated Annual Usage

Trim length

Outer diameter

Internal Ø

Usable width

C:

B:

A:

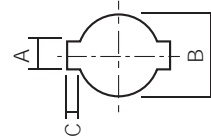

If demanding inner bore with keyway, please check the dimension values A, B and C.

Company name:

Phone:

E-mail:



JAZ-ZUBIAURRE, S.A. Phone: + 34 943 120 600 / Fax: + 34 943 121 704 / jaz@jaz.es / www.jaz.es

Drawing for brush type TO

MATERIAL (Mark with an "X") DIMENSIONS

Estimated Annual Usage

<input type="checkbox"/>	GREY STEEL
<input type="checkbox"/>	BRASS COATED STEEL
<input type="checkbox"/>	STAINLESS STEEL
<input type="checkbox"/>	BRASS
<input type="checkbox"/>	LAMINATED WIRE
Wire diameter	
<input type="checkbox"/>	0,08mm / .003"
<input type="checkbox"/>	0,12mm / .005"
<input type="checkbox"/>	0,15mm / .006"
<input type="checkbox"/>	0,20mm / .008"
<input type="checkbox"/>	0,30mm / .012"
<input type="checkbox"/>	0,35mm / .013"
<input type="checkbox"/>	0,40mm / .016"
<input type="checkbox"/>	0,50mm / .020"
<input type="checkbox"/>	0,80mm / .032"
<input type="checkbox"/>	CABLE CRIMPED WIRE
Cable crimped wire diameter	
<input type="checkbox"/>	6w x 0,35mm + 3h x 0,20mm / 6w x .013" + 3w x .008"
<input type="checkbox"/>	12w x 0,23mm / 12h x .009"
<input type="checkbox"/>	STAINLESS STEEL CABLE WIRE
Stainless steel cable wire diameter	
<input type="checkbox"/>	7w x 0,35mm / 7w x .013"

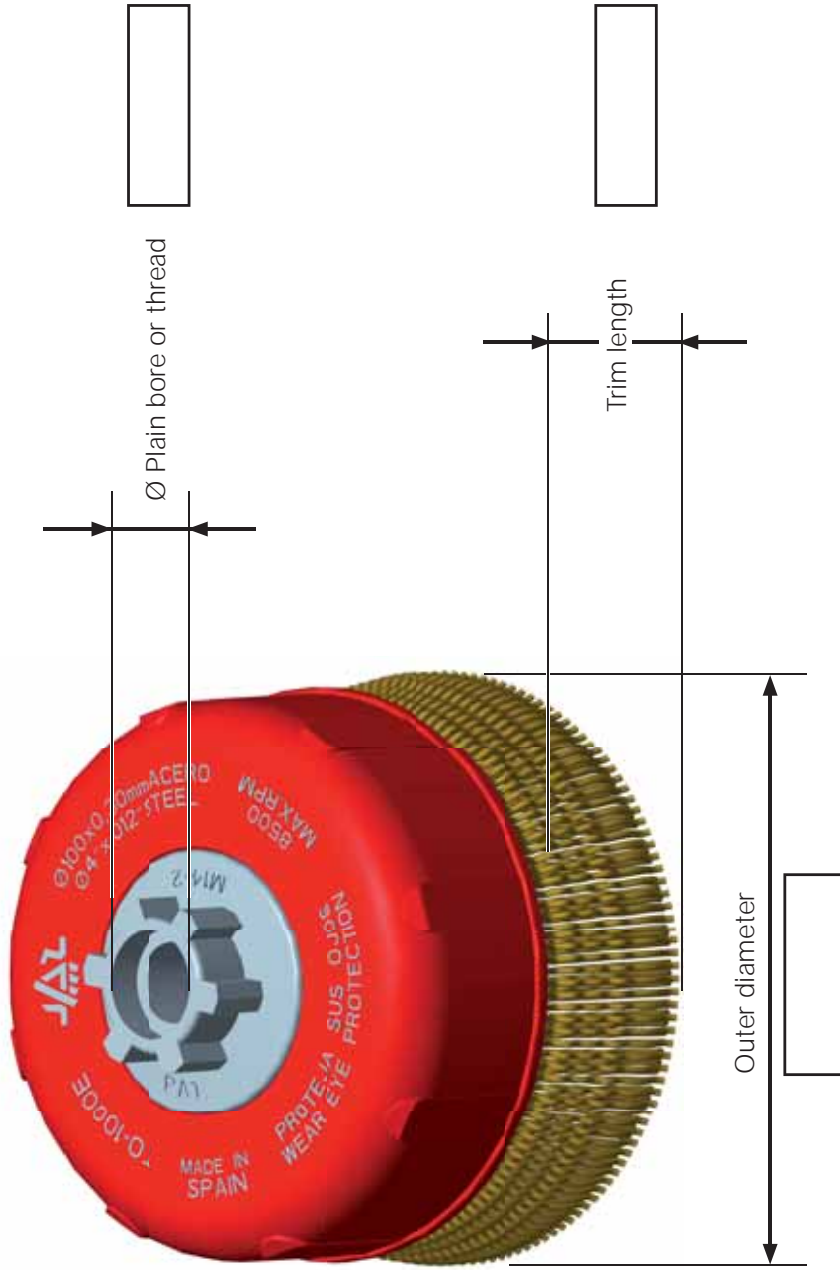

Company name:

Phone:

E-mail:

Drawing for brush type TT

MATERIAL (Mark with an "X") DIMENSIONS

- GREY STEEL
- BRASS COATED STEEL
- STAINLESS STEEL
- BRASS
- LAMINATED WIRE

Wire diameter

- 0,37mm / .014"
- 0,40mm / .016"
- 0,50mm / .020"
- 0,80mm / .032"

Estimated Annual Usage



Ø Plain bore or thread type

Number of knots:

Trim length

Outer diameter

Company name:

Phone:

E-mail:



JAZ-ZUBIAURRE, S.A. Phone: + 34 943 120 600 / Fax: + 34 943 121 704 / jaz@jaz.es / www.jaz.es

Drawing for brush type END BRUSHES

MATERIAL (Mark with an "X") DIMENSIONS

Estimated Annual Usage

- GREY STEEL
- BRASS COATED STEEL
- STAINLESS STEEL
- STAINLESS STEEL CABLE WIRE
- BRASS
- GERMAN SILVER
- LAMINATED WIRE
- NYLON

Wire diameter

- 0,15mm / .006"
- 0,30mm / .012"
- 0,35mm / .013"
- 0,37mm / .014"
- 0,40mm / .016"
- 0,50mm / .020"

- CABLE CRIMPED WIRE

Cable crimped wire diameter

- 6w x 0,35mm+ 3h x0,20mm / 6w x .013" + 3w x .008"
- 12w x 0,23mm / 12h x .009"

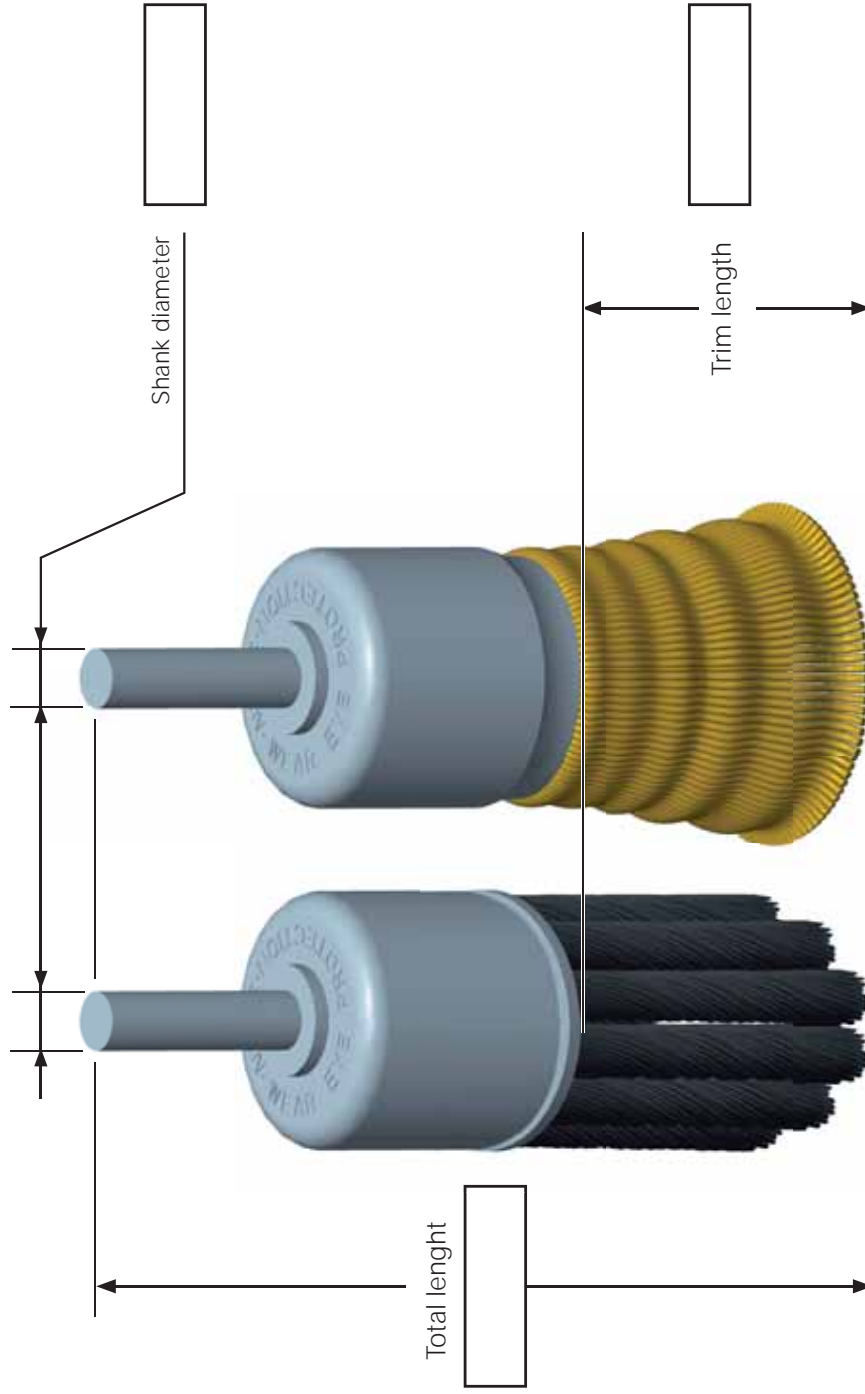

Company name:

Phone:

E-mail:



JAZ ZUBIAURRE, S.A. Phone: + 34 943 120 600 / Fax: + 34 943 121 704 / jaz@jaz.es / www.jaz.es

Drawing for brush type TUBE BRUSHES

MATERIAL (Mark with an "X") DIMENSIONS

Estimated Annual Usage

- BRASS COATED STEEL
- STAINLESS STEEL
- NYLON ABRASIVO (Grano 120)
- NYLON ABRASIVO (Grano 180)
- NYLON ABRASIVO (Grano 320)
- BRASS
- NYLON
- PELO DE CABALLO

Wire diameter

- 0,25mm / .009"
- 0,30mm / .012"
- 0,40mm / .016"
- 0,50mm / .020"

Tipo de Espiral

- L1 Espiral Simple
- L2 Espiral Doble

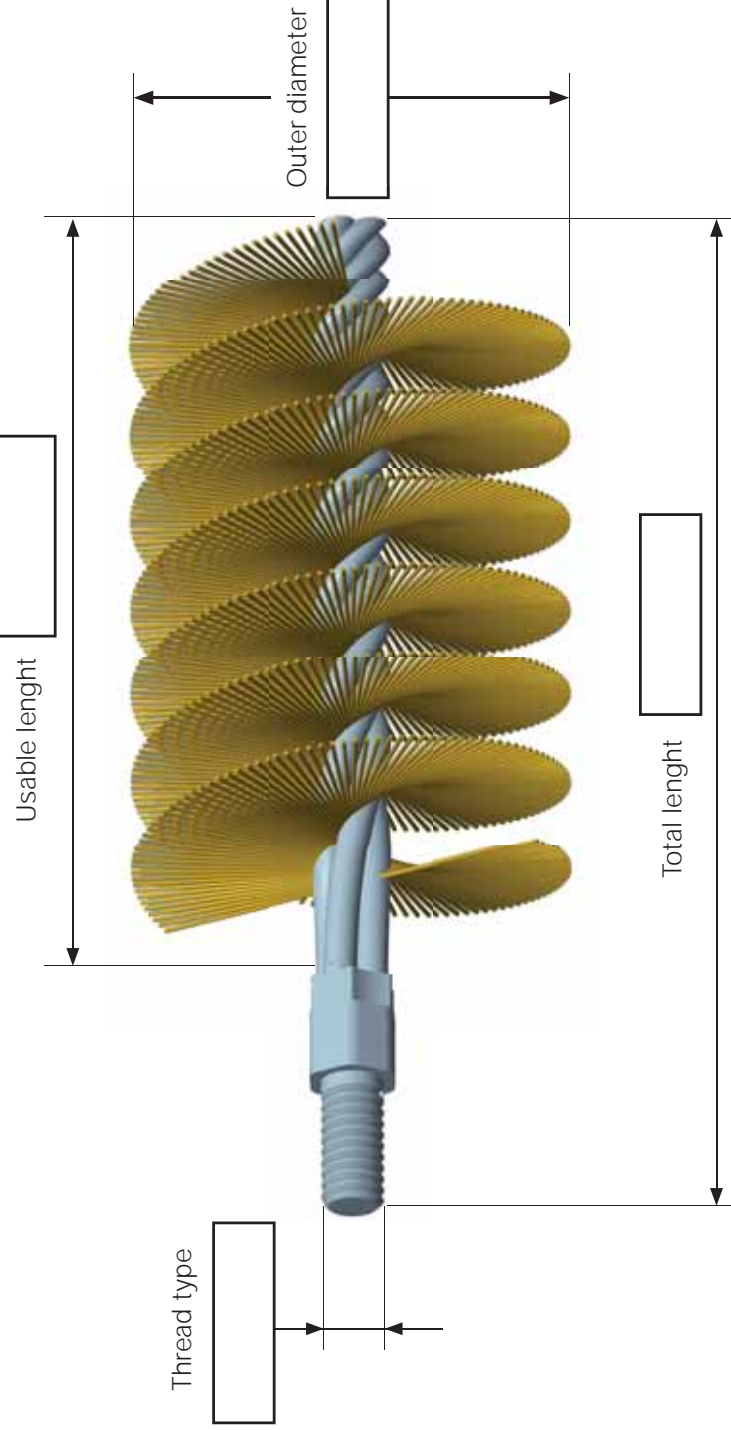

Company name:

Phone:

E-mail:



JAZ ZUBIAURRE, S.A. Phone: + 34 943 120 600 / Fax: + 34 943 121 704 / jaz@jaz.es / www.jaz.es

DNA nylon abrasive wheel brushes drawing

DIMENSIONS

MATERIAL (Mark with an "X")

Estimated Annual Usage

Nylon types

GRIT 120

GRIT 180

GRIT 320

ANOTHER TYPE OF GRIT

Trim length

Internal Ø

Usable width

Outer diameter

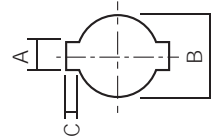

If demanding inner bore with keyway, please check the dimension values A, B and C.

A:

B:

C:

Company name:

Phone:

E-mail:



JAZ-ZUBIAURRE, S.A. Phone: + 34 943 120 600 / Fax: + 34 943 121 704 / jaz@jaz.es / www.jaz.es

Product Liability Insurance Policy

PRODUCT LIABILITY INSURANCE POLICY	
Insurance Policy: 096-9980037359	JAZ-ZUBIAURRE S.A. Pol. Ind. Azitain 20600 EIBAR (SPAIN)
Holder:	
COVER: 901.518 €	

Quality Assurance System

JAZ-ZUBIAURRE S.A. has been certified by Bureau Veritas through its Certificated No. 7000689 which proves our accomplishment with the requirements of the Standard ISO 9001: 2000.



Innovation System

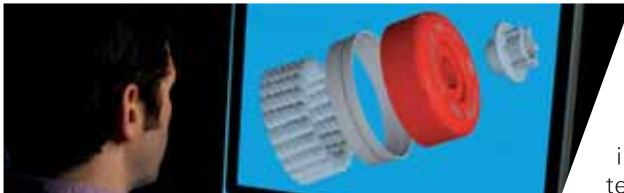

At JAZ-ZUBIAURRE, S.A. we work methodically on our knowledge development and the continuous improvement of our products and processes. In the last years we have registered several invention patents and achieved awards for technological innovation.



www.jaz.es

In our web site customers may find updated contents with our latest developments as well as informative videos about our firm, products and applications.



User´s Handbook

Included in each packed product of our industrial range, this useful handbook provides a complete technical and commercial information for the end user.



JAZ-ZUBIAURRE S.A.





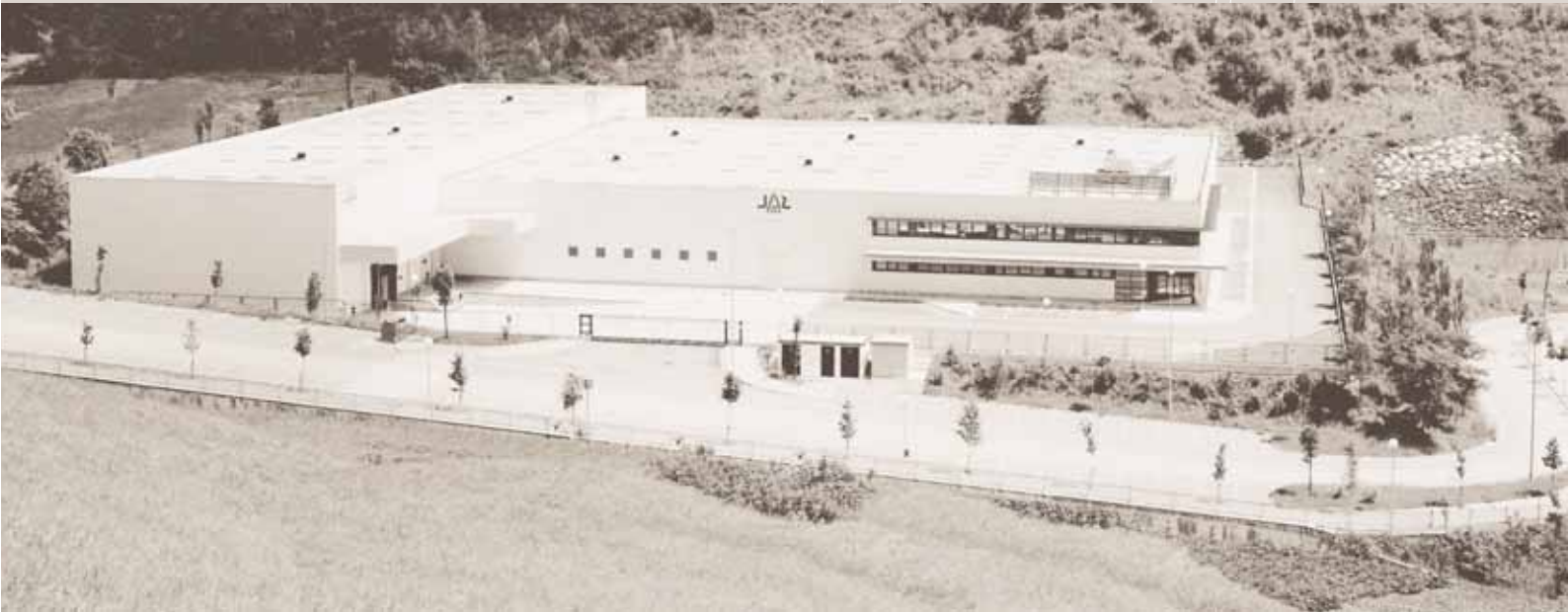

JAZ
JAZ-ZUBIAURRE S.A.



Polígono Ind. Azitain, nº 4
P.O.BOX 50
20.600 Eibar (SPAIN)
Phone: (+34) 943 12 06 00
(+34) 943 70 70 22
Fax: (+34)943 12 17 04
jaz@jaz.es
www.jaz.es